

# KM UNF

## Counter nut

### Properties

<b>Connection 1</b>	UN/UNF inner thread
<b>Design</b>	Counter nut
<b>Standard</b>	ISO 8434-2
<b>Material</b>	Steel
<b>Surface</b>	electro galvanised

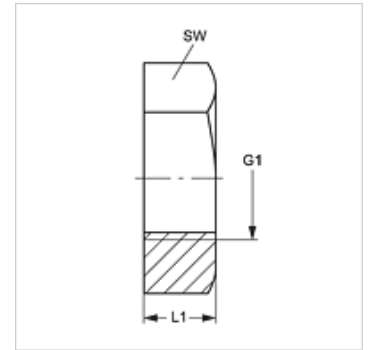

### Item

Identification	G1	L1 (mm)	AF (mm)
<b>KM 04 UNF</b>	7/16"-20 UNF	6,4	17
<b>KM 05 UNF</b>	1/2"-20 UNF	6,4	19
<b>KM 06 UNF</b>	9/16"-18 UNF	6,9	22
<b>KM 08 UNF</b>	3/4"-16 UNF	7,9	24
<b>KM 10 UNF</b>	7/8" -14 UNF	9,1	30
<b>KM 12 UNF</b>	1.1/16" -12 UN	10,4	36
<b>KM 16 UNF</b>	1.5/16" -12 UN	10,4	41
<b>KM 20 UNF</b>	1.5/8" -12 UN	10,4	50
<b>KM 24 UNF</b>	1.7/8" -12 UN	10,4	55
<b>KM 32 UNF</b>	2.1/2" -12 UN	10,4	70

AF = Width across flats