

W90 HJOF LOET

Soldered socket, angle 90°

Properties

Connection 1 ORFS external threads

Sealing form 1 flat seal with O-ring

Connection 2 Soldered socket

Design Soldered socket

Construction Angle 90°

Material Steel

Surface oiled

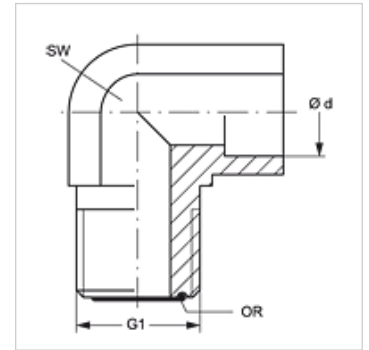

Item

Identification	Ø d (mm)	G1	AF (mm)	OR
W90 HJOF 04 LOET 06	6	9/16"-18 UNF	14	7.65 x 1.78
W90 HJOF 06 LOET 10	10	11/16" -16 UN	19	9.25 x 1.78
W90 HJOF 08 LOET 12	12	13/16" -16 UN	19	12.42 x 1.78
W90 HJOF 10 LOET 16	16	1" -14 UNS	27	15.60 x 1.78
W90 HJOF 12 LOET 18	18	1.3/16" -12 UN	30	18.77 x 1.78
W90 HJOF 12 LOET 20	20	1.3/16" -12 UN	30	18.77 x 1.78
W90 HJOF 16 LOET 25	25	1.7/16" -12 UN	36	23.52 x 1.78

Ø = External pipe diameter