

AFS 90 ST M (3000 / 6000 PSI)

SAE welded on flange, angle 90°

HANSA FLEX

Properties

| | |
|------------------------|----------------------------------|
| Standard | SAE J 518 C ISO 6162 |
| Construction | Angle 90° |
| Design | SAE welded on flange |
| Mounting | with metric screw set |
| Scope of supply | with metric screw set and O-ring |
| Material | S355J2G3 (ST52.3) |
| Surface | black oiled |

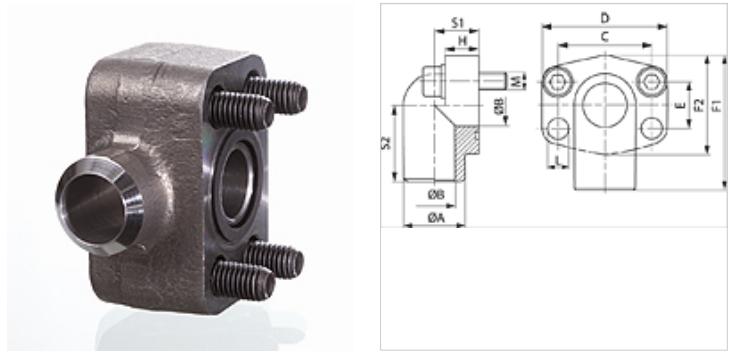

Note

The stated maximum working pressure relates to the flange. The actual working pressure is determined by the pipe (wall thickness) and the quality of the pipe.

Item

| Identification | Pressure series | PB 10.9 | Size | Ø A | Ø B | C | D | E | F1 | F2 | H | S1 | S2 | L | Screws |
|-----------------|-----------------|---------|--------|------|------|------|------|------|------|------|------|------|------|------|-----------------|
| | | (bar) | | (mm) | (mm) | (mm) | (mm) | (mm) | (mm) | (mm) | (mm) | (mm) | (mm) | (mm) | |
| AFS 200/90 ST M | 3000 PSI | 350 | 3/4" | 27,0 | 19 | 47,6 | 70 | 22,2 | 63 | 50 | 21,0 | 23,0 | 41 | 11,0 | (4 x) M 10 x 40 |
| AFS 202/90 ST M | 3000 PSI | 315 | 1" | 34,5 | 23 | 52,4 | 75 | 26,2 | 72 | 60 | 24,0 | 25,0 | 48 | 11,0 | (4 x) M 10 x 45 |
| AFS 204/90 ST M | 3000 PSI | 250 | 1.1/4" | 43,0 | 31 | 58,7 | 86 | 30,2 | 82 | 68 | 25,0 | 27,0 | 54 | 11,5 | (4 x) M 10 x 45 |
| AFS 206/90 ST M | 3000 PSI | 200 | 1.1/2" | 50,0 | 35 | 69,9 | 97 | 35,7 | 92 | 78 | 29,0 | 31,5 | 57 | 14,0 | (4 x) M 12 x 50 |
| AFS 208/90 ST M | 3000 PSI | 200 | 2" | 65,0 | 48 | 77,8 | 100 | 42,9 | 99 | 90 | 50,0 | 37,5 | 63 | 14,0 | (4 x) M 12 x 70 |
| AFS 700/90 ST M | 6000 PSI | 400 | 3/4" | 28,0 | 19 | 50,8 | 71 | 23,8 | 70 | 60 | 19,0 | 22,0 | 40 | 11,0 | (4 x) M 10 x 35 |
| AFS 702/90 ST M | 6000 PSI | 400 | 1" | 35,0 | 25 | 57,2 | 81 | 27,8 | 82 | 70 | 24,0 | 27,0 | 47 | 13,0 | (4 x) M 10 x 45 |
| AFS 704/90 ST M | 6000 PSI | 375 | 1.1/4" | 42,0 | 32 | 66,7 | 95 | 31,8 | 95 | 78 | 27,0 | 32,0 | 56 | 15,0 | (4 x) M 14 x 50 |
| AFS 706/90 ST M | 6000 PSI | 320 | 1.1/2" | 48,0 | 38 | 79,4 | 113 | 36,5 | 115 | 94 | 30,0 | 40,0 | 68 | 17,0 | (4 x) M 16 x 50 |

PN = Nominal pressure PB = Max. operating pressure

Product versions

AFS 90 ST (3000 PSI) SAE welded on flange, angle 90°, flange only