

# WF LK

Pump connection (4 hole), angle 90°

**HANSA FLEX**

## Properties

<b>Design</b>	Pump connection (4 hole)
<b>Construction</b>	Angle 90°
<b>Standard</b>	DIN 3901/3902
<b>Mounting</b>	with metric screw set
<b>Scope of supply</b>	with metric screw set and O-ring
<b>Material</b>	Malleable cast iron GTW 40
<b>Surface</b>	electro galvanised

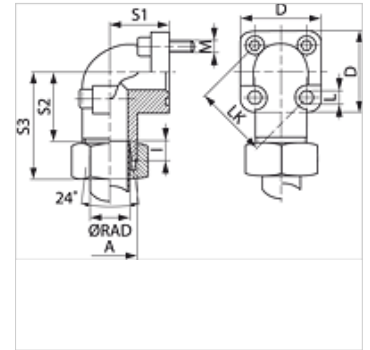

## Note

The stated maximum working pressure relates to the flange. The actual working pressure is determined by the pipe (wall thickness) and the quality of the pipe.

## Item

Identification	Series	I	Ø RAD	Pressure PB	A	LK	D	S1	S2	L	Screws 1	Screws 2	OR
		(mm)	(mm)	(bar)		(mm)	(mm)	(mm)	(mm)	(mm)			
WF 35 LK L 10 315	L	14,0	10	315	M16x1,5	35	39	16,5	30,5	6,4	(2x) M 6 x 22	(2x) M 6 x 35	20.0 x 2.5
WF 35 LK L 12 315	L	14,0	12	315	M18x1,5	35	39	16,5	30,5	6,4	(2x) M 6 x 22	(2x) M 6 x 35	20.0 x 2.5
WF 35 LK L 15 250	L	14,0	15	250	M22x1,5	35	39	16,5	30,0	6,4	(2x) M 6 x 22	(2x) M 6 x 35	20.0 x 2.5
WF 35 LK L 18 250	L	15,0	18	250	M26x1,5	35	39	20,0	30,0	6,4	(2x) M 6 x 22	(2x) M 6 x 40	20.0 x 2.5
WF 40 LK L 15 100	L	20,0	15	100	M22x1,5	40	42	22,5	30,0	6,4	(2x) M 6 x 22	(2x) M 6 x 45	26.0 x 2.5
WF 40 LK L 18 100	L	20,0	18	100	M26x1,5	40	42	22,5	30,5	6,4	(2x) M 6 x 22	(2x) M 6 x 45	26.0 x 2.5
WF 40 LK L 22 100	L	20,0	22	100	M30x2	40	42	22,5	30,5	6,4	(2x) M 6 x 22	(2x) M 6 x 45	26.0 x 2.5
WF 40 LK L 28 100	L	20,0	28	100	M36x2	40	42	28,0	32,5	6,4	(2x) M 6 x 22	(2x) M 6 x 50	26.0 x 2.5
WF 40 LK L 35 100	L	20,0	35	100	M45x2	40	42	34,0	30,5	6,4	(2x) M 6 x 22	(2x) M 6 x 60	26.0 x 2.5
WF 55 LK L 35 100	L	26,0	35	100	M45x2	55	58	32,0	38,5	8,4	(2x) M 8 x 25	(2x) M 8 x 60	32.0 x 2.5
WF 55 LK L 42 100	L	26,0	42	100	M52x2	55	58	40,0	38,0	8,4	(2x) M 8 x 25	(2x) M 8 x 70	32.0 x 2.5
WF 35 LK S 16 315	S	15,0	16	315	M24x1,5	35	39	20,0	29,5	6,4	(2x) M 6 x 22	(2x) M 6 x 40	20.0 x 2.5
WF 35 LK S 20 315	S	15,0	20	315	M30x2	35	39	25,0	34,5	6,4	(2x) M 6 x 22	(2x) M 6 x 45	20.0 x 2.5
WF 40 LK S 20 250	S	20,0	20	250	M30x2	40	42	22,5	29,5	6,4	(2x) M 6 x 22	(2x) M 6 x 45	26.0 x 2.5
WF 55 LK S 20 250	S	18,0	20	250	M30x2	55	58	30,0	34,5	8,4	(2x) M 8 x 25	(2x) M 8 x 55	32.0 x 2.5
WF 55 LK S 25 250	S	20,0	25	250	M36x2	55	58	30,0	37,0	8,4	(2x) M 8 x 25	(2x) M 8 x 55	32.0 x 2.5
WF 55 LK S 30 250	S	26,0	30	250	M42x2	55	58	32,0	35,5	8,4	(2x) M 8 x 25	(2x) M 8 x 50	32.0 x 2.5

Series: LL = Very light L = Light S = Heavy - PN = Nominal pressure PB = Max. operating pressure - Ø RAD = External pipe diameter

## Product versions

**WF LK M** Pump connection (4 hole), angle 90°, with screw set, O-ring, nut and cutting ring