

WF LK M

Pump connection (4 hole), angle 90°

HANSA FLEX

Properties

Design	Pump connection (4 hole)
Construction	Angle 90°
Standard	DIN 3901/3902
Mounting	with metric screw set
Scope of supply	with screw set, O-ring, nut and cutting ring
Material	Malleable cast iron GTW 40
Surface	electro galvanised

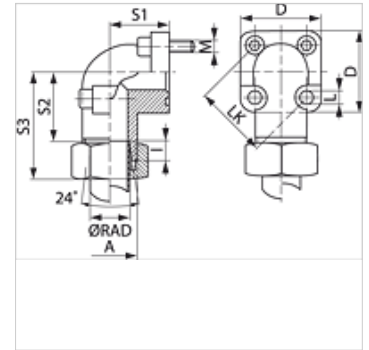

Item

Identification	Series	I	Ø RAD (mm)	Pressure PB (bar)	A	LK	D	S1	S2	S3	L	Screws 1	Screws 2	OR
WF 35 LK L 10 315 M	L	14,0	10	315	M16x1,5	35	39	16,5	30,5	47,0	6,4	(2x) M 6 x 22	(2x) M 6 x 35	20.0 x 2.5
WF 35 LK L 12 315 M	L	14,0	12	315	M18x1,5	35	39	16,5	30,5	47,0	6,4	(2x) M 6 x 22	(2x) M 6 x 35	20.0 x 2.5
WF 35 LK L 15 250 M	L	14,0	15	250	M22x1,5	35	39	16,5	30,0	46,0	6,4	(2x) M 6 x 22	(2x) M 6 x 35	20.0 x 2.5
WF 35 LK L 18 250 M	L	15,0	18	250	M26x1,5	35	39	20,0	30,0	47,5	6,4	(2x) M 6 x 22	(2x) M 6 x 40	20.0 x 2.5
WF 40 LK L 15 100 M	L	20,0	15	100	M22x1,5	40	42	22,5	30,0	46,0	6,4	(2x) M 6 x 22	(2x) M 6 x 45	26.0 x 2.5
WF 40 LK L 18 100 M	L	20,0	18	100	M26x1,5	40	42	22,5	30,5	47,0	6,4	(2x) M 6 x 22	(2x) M 6 x 45	26.0 x 2.5
WF 40 LK L 22 100 M	L	20,0	22	100	M30x2	40	42	22,5	30,5	47,5	6,4	(2x) M 6 x 22	(2x) M 6 x 45	26.0 x 2.5
WF 40 LK L 28 100 M	L	20,0	28	100	M36x2	40	42	28,0	32,5	49,0	6,4	(2x) M 6 x 22	(2x) M 6 x 50	26.0 x 2.5
WF 40 LK L 35 100 M	L	20,0	35	100	M45x2	40	42	34,0	30,5	52,0	6,4	(2x) M 6 x 22	(2x) M 6 x 60	26.0 x 2.5
WF 55 LK L 35 100 M	L	26,0	35	100	M45x2	55	58	32,0	38,5	62,0	8,4	(2x) M 8 x 25	(2x) M 8 x 60	32.0 x 2.5
WF 55 LK L 42 100 M	L	26,0	42	100	M52x2	55	58	40,0	38,0	61,0	8,4	(2x) M 8 x 25	(2x) M 8 x 70	32.0 x 2.5
WF 35 LK S 16 315 M	S	15,0	16	315	M24x1,5	35	39	20,0	29,5	48,0	6,4	(2x) M 6 x 22	(2x) M 6 x 40	20.0 x 2.5
WF 35 LK S 20 315 M	S	15,0	20	315	M30x2	35	39	25,0	34,5	56,0	6,4	(2x) M 6 x 22	(2x) M 6 x 45	20.0 x 2.5
WF 40 LK S 20 250 M	S	20,0	20	250	M30x2	40	42	22,5	29,5	50,0	6,4	(2x) M 6 x 22	(2x) M 6 x 45	26.0 x 2.5
WF 55 LK S 20 250 M	S	18,0	20	250	M30x2	55	58	24,0	34,5	56,0	8,4	(2x) M 8 x 25	(2x) M 8 x 50	32.0 x 2.5
WF 55 LK S 25 250 M	S	20,0	25	250	M36x2	55	58	30,0	37,0	61,0	8,4	(2x) M 8 x 25	(2x) M 8 x 55	32.0 x 2.5
WF 55 LK S 30 250 M	S	26,0	30	250	M42x2	55	58	32,0	35,5	62,0	8,4	(2x) M 8 x 25	(2x) M 8 x 50	32.0 x 2.5

Series: LL = Very light L = Light S = Heavy – PN = Nominal pressure PB = Max. operating pressure – Ø RAD = External pipe diameter

Product versions

WF LK Pump connection (4 hole), angle 90°, with metric screw set and O-ring