

# WFG (3000 PSI)

## SAE flange adapter, forged

### Properties

Pressure series	3000 psi
Standard	DIN 3901/3902
Construction type	forged
Construction	Angle 90°
Design	SAE flange adapter
Scope of supply	flange only
Material	S355J2G3 (ST52.3)
Surface	electro galvanised

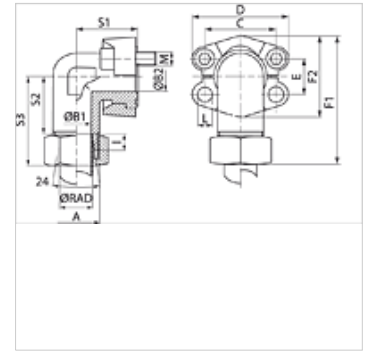

### Note

The stated maximum working pressure relates to the flange. The actual working pressure is determined by the pipe (wall thickness) and the quality of the pipe.

Recommended screws are listed in the columns M (metr) and M (unc).

### Item

Identification	Series	Ø RAD (mm)	PB 10.9 (bar)	Size	A	B1 (mm)	B2 (mm)	F1 (mm)	I (mm)	S1 (mm)	S2 (mm)	S3 (mm)	L (mm)	M metr.
WFG 3001/L 15	L	15	315	1/2"	M22x1,5	12	11	66,8	7,0	39	29,0	44	8,7	M 8 x 25
WFG 3002/L 18	L	18	315	3/4"	M26x1,5	15	19	73,9	7,5	42	31,5	48	10,7	M 10 x 35
WFG 3002/L 22	L	22	160	3/4"	M30x2	19	19	75,9	7,5	42	33,5	50	10,7	M 10 x 35
WFG 3003/L 28	L	28	160	1"	M36x2	24	25	82,2	7,5	45	36,5	53	10,7	M 10 x 35
WFG 3004/L 35	L	35	160	1.1/4"	M45x2	30	27	104,3	10,5	50	46,5	68	*1	*2
WFG 3005/L 42	L	42	160	1.1/2"	M52x2	36	36	118,2	11,0	55	47,0	57	13,5	M 12 x 40
WFG 3001/S 16	S	16	350	1/2"	M24x1,5	12	11	70,8	8,5	39	29,5	48	8,7	M 8 x 25
WFG 3002/S 20	S	20	350	3/4"	M30x2	16	19	79,9	10,5	42	32,5	54	10,7	M 10 x 35
WFG 3002/S 25	S	25	350	3/4"	M36x2	17	19	82,9	12,0	42	33,0	57	10,7	M 10 x 35
WFG 3003/S 25	S	25	315	1"	M36x2	20	25	91,2	12,0	45	38,0	62	10,7	M 10 x 35
WFG 3003/S 30	S	30	315	1"	M42x2	24	25	92,2	13,5	45	36,5	63	10,7	M 10 x 35
WFG 3004/S 25	S	25	250	1.1/4"	M36x2	20	27	103,3	12,0	50	43,0	67	*1	*2
WFG 3004/S 30	S	30	250	1.1/4"	M42x2	25	27	106,3	13,5	50	43,5	70	*1	*2
WFG 3004/S 38	S	38	250	1.1/4"	M52x2	28	27	110,3	16,0	50	43,0	74	*1	*2
WFG 3005/S 38	S	38	200	1.1/2"	M52x2	32	36	128,2	16,0	55	48,0	58	13,5	M 12 x 40

Series: LL = Very light L = Light S = Heavy - PN = Nominal pressure PB = Max. operating pressure - Ø RAD = External pipe diameter

\*1) = Choice of 10.5 or 12.5 - \*2) = Choice of M 10 x 30 or M 12 x 40

### Product versions

**WFG M (3000 / 6000 PSI)** SAE flange adapter, forged, with 2 flange halves, screw set and O-ring