

WFG M (3000 / 6000 PSI)

SAE flange adapter, forged

HANSA FLEX

Properties

| | |
|-------------------|--|
| Standard | DIN 3901/3902 |
| Construction type | forged |
| Construction | Angle 90° |
| Design | SAE flange adapter |
| Scope of supply | with 2 flange halves, screw set and O-ring |
| Material | S355J2G3 (ST52.3) |
| Surface | electro galvanised |

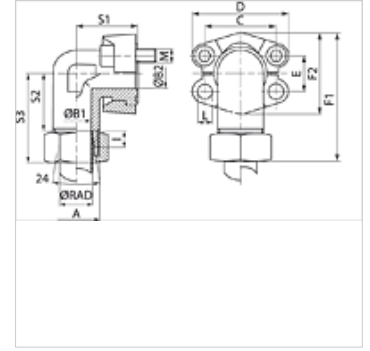

Note

The stated maximum working pressure relates to the flange. The actual working pressure is determined by the pipe (wall thickness) and the quality of the pipe.

Item

| Identification | Pressure series | Se-ries | Ø RAD | PB 10.9 | Size | A | B1 | B2 | C | D | E | F1 | F2 | I | S1 | S2 | S3 | L | Screws |
|---------------------|-----------------|---------|-------|---------|--------|---------|------|------|------|-------|------|-------|------|------|------|------|------|------|-----------------|
| | | | (mm) | (bar) | | | (mm) | (mm) | (mm) | (mm) | (mm) | (mm) | (mm) | (mm) | (mm) | (mm) | (mm) | (mm) | |
| WFG 3001/L 15 M | 3000 PSI | L | 15 | 315 | 1/2" | M22x1,5 | 12 | 11 | 38,1 | 54,0 | 17,5 | 66,8 | 45,6 | 7,0 | 39 | 29,0 | 44 | 8,7 | (4 x) M 8 x 25 |
| WFG 3002/L 18 M | 3000 PSI | L | 18 | 315 | 3/4" | M26x1,5 | 15 | 19 | 47,6 | 64,9 | 22,2 | 73,9 | 51,8 | 7,5 | 42 | 31,5 | 48 | 10,7 | (4 x) M 10 x 30 |
| WFG 3002/L 22 M | 3000 PSI | L | 22 | 160 | 3/4" | M30x2 | 19 | 19 | 47,6 | 64,9 | 22,2 | 75,9 | 51,8 | 7,5 | 42 | 33,5 | 50 | 10,7 | (4 x) M 10 x 30 |
| WFG 3003/L 28 M | 3000 PSI | L | 28 | 160 | 1" | M36x2 | 24 | 25 | 52,4 | 69,9 | 26,2 | 82,2 | 58,4 | 7,5 | 45 | 36,5 | 53 | 10,7 | (4 x) M 10 x 30 |
| WFG 3004/L 35 M | 3000 PSI | L | 35 | 160 | 1.1/4" | M45x2 | 30 | 27 | 58,7 | 79,4 | 30,2 | 104,3 | 72,6 | 10,5 | 50 | 46,5 | 68 | *1 | *2 |
| WFG 3005/L 42 M | 3000 PSI | L | 42 | 160 | 1.1/2" | M52x2 | 36 | 36 | 69,9 | 93,8 | 35,7 | 118,2 | 82,4 | 11,0 | 76 | 56,0 | 77 | 13,5 | (4 x) M 12 x 40 |
| WFG 3001/S 16 M | 3000 PSI | S | 16 | 350 | 1/2" | M24x1,5 | 12 | 11 | 38,1 | 54,0 | 17,5 | 70,8 | 45,6 | 8,5 | 39 | 29,5 | 48 | 8,7 | (4 x) M 8 x 25 |
| WFG 3002/S 20 M | 3000 PSI | S | 20 | 350 | 3/4" | M30x2 | 16 | 19 | 47,6 | 64,9 | 22,2 | 79,9 | 51,8 | 10,5 | 42 | 32,5 | 54 | 10,7 | (4 x) M 10 x 30 |
| WFG 3002/S 25 M | 3000 PSI | S | 25 | 350 | 3/4" | M36x2 | 17 | 19 | 47,6 | 64,9 | 22,2 | 82,9 | 51,8 | 12,0 | 42 | 33,0 | 57 | 10,7 | (4 x) M 10 x 30 |
| WFG 3003/S 25 M | 3000 PSI | S | 25 | 315 | 1" | M36x2 | 20 | 25 | 52,4 | 69,9 | 26,2 | 91,2 | 58,4 | 12,0 | 45 | 38,0 | 62 | 10,7 | (4 x) M 10 x 30 |
| WFG 3003/S 30 M | 3000 PSI | S | 30 | 315 | 1" | M42x2 | 24 | 25 | 52,4 | 69,9 | 26,2 | 92,2 | 58,4 | 13,5 | 45 | 36,5 | 63 | 10,7 | (4 x) M 10 x 30 |
| WFG 3004/S 25 M | 3000 PSI | S | 25 | 250 | 1.1/4" | M36x2 | 20 | 27 | 58,7 | 79,4 | 30,2 | 103,3 | 72,6 | 12,0 | 50 | 43,0 | 67 | *1 | *2 |
| WFG 3004/S 30 M | 3000 PSI | S | 30 | 250 | 1.1/4" | M42x2 | 25 | 27 | 58,7 | 79,4 | 30,2 | 106,3 | 72,6 | 13,5 | 50 | 43,5 | 70 | *1 | *2 |
| WFG 3004/S 38 M | 3000 PSI | S | 38 | 250 | 1.1/4" | M52x2 | 28 | 27 | 58,7 | 79,4 | 30,2 | 110,3 | 72,6 | 16,0 | 50 | 43,0 | 74 | *1 | *2 |
| WFG 3005/S 38 M | 3000 PSI | S | 38 | 200 | 1.1/2" | M52x2 | 32 | 36 | 69,9 | 93,8 | 35,7 | 128,2 | 82,4 | 16,0 | 76 | 56,0 | 87 | 13,5 | (4 x) M 12 x 40 |
| WFG 6001/S 16 M | 6000 PSI | S | 16 | 400 | 1/2" | M24x1,5 | 12 | 12 | 40,5 | 56,4 | 18,2 | 71,6 | 47,2 | 8,5 | 39 | 29,4 | 48 | 8,7 | (4 x) M 8 x 30 |
| WFG 6002/S 16 M | 6000 PSI | S | 16 | 400 | 3/4" | M24x1,5 | 12 | 17 | 50,8 | 71,3 | 23,8 | 85,0 | 60,0 | 8,5 | 48 | 36,5 | 55 | 10,7 | (4 x) M 10 x 35 |
| WFG 6002/S 20 M | 6000 PSI | S | 20 | 400 | 3/4" | M30x2 | 16 | 17 | 50,8 | 71,3 | 23,8 | 87,0 | 60,0 | 10,5 | 48 | 35,5 | 57 | 10,7 | (4 x) M 10 x 35 |
| WFG 6002/S 25 M | 6000 PSI | S | 25 | 400 | 3/4" | M36x2 | 17 | 17 | 50,8 | 71,3 | 23,8 | 90,0 | 60,0 | 12,0 | 48 | 36,0 | 60 | 10,7 | (4 x) M 10 x 35 |
| WFG 6003/S 25 M | 6000 PSI | S | 25 | 400 | 1" | M36x2 | 20 | 24 | 57,2 | 81,0 | 27,8 | 99,8 | 69,0 | 12,0 | 60 | 41,0 | 65 | 13,0 | (4 x) M 12 x 45 |
| WFG 6003/S 30 M | 6000 PSI | S | 30 | 400 | 1" | M42x2 | 24 | 24 | 57,2 | 81,0 | 27,8 | 102,9 | 69,0 | 13,5 | 60 | 41,5 | 68 | 13,0 | (4 x) M 12 x 45 |
| WFG 6004/S 30 M | 6000 PSI | S | 30 | 400 | 1.1/4" | M42x2 | 25 | 31 | 66,7 | 95,2 | 31,8 | 109,6 | 77,2 | 13,5 | 68 | 44,5 | 71 | 14,7 | (4 x) M 14 x 50 |
| WFG 6004/S 38 M | 6000 PSI | S | 38 | 350 | 1.1/4" | M52x2 | 28 | 31 | 66,7 | 95,2 | 31,8 | 114,6 | 77,2 | 16,0 | 68 | 45,0 | 76 | 14,7 | (4 x) M 14 x 50 |
| WFG 6004/S 38-400 M | 6000 PSI | S | 38 | 400 | 1.1/4" | M52x2 | 22 | 24 | 66,7 | 95,2 | 31,8 | 114,5 | 77,2 | 16,0 | 68 | 45,0 | 76 | 14,7 | (4 x) M 14 x 50 |
| WFG 6005/S 38 M | 6000 PSI | S | 38 | 350 | 1.1/2" | M52x2 | 30 | 36 | 79,4 | 112,8 | 36,5 | 134,5 | 95,0 | 16,0 | 76 | 56,0 | 87 | 17,0 | (4 x) M 16 x 55 |

Series: LL = Very light L = Light S = Heavy – PN = Nominal pressure PB = Max. operating pressure – Ø RAD = External pipe diameter

*1) = Choice of 10.5 or 12.5 – *2) = Choice of M 10 x 30 or M 12 x 40

Product versions

WFG (3000 PSI) SAE flange adapter, forged, flange only