

WFG JIC (6000 PSI)

SAE flange adapter, forged

HANSA FLEX

Properties

Pressure series	6000 psi
Standard	SAE J 518 C ISO 6162
Construction type	forged
Construction	Angle 90°
Design	SAE flange adapter
Scope of supply	flange only
Material	S355J2G3 (ST52.3)
Surface	electro galvanised

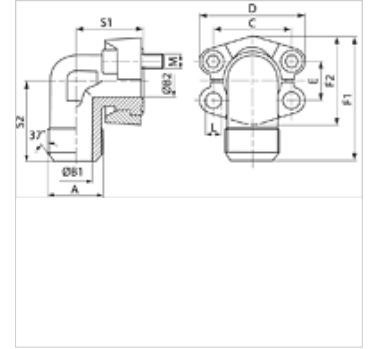

Note

The stated maximum working pressure relates to the flange. The actual working pressure is determined by the pipe (wall thickness) and the quality of the pipe.

Recommended screws are listed in the columns M (metr) and M (unc).

Item

Identification	PB 10.9 (bar)	Size	A	B1 (mm)	B2 (mm)	E (mm)	F1 (mm)	S1 (mm)	S2 (mm)	L (mm)	M metr.	M unc
WFG 6001 JIC 3/4	400	1/2"	UNF 3/4" -16	9,9	13	18,2	61,6	39	38	8,7	M 8 x 30	5/16" x 1.1/4"
WFG 6001 JIC 7/8	400	1/2"	UNF 7/8" -14	12,3	13	18,2	61,6	39	38	8,7	M 8 x 35	5/16" x 1.1/4"
WFG 6002 JIC 1 1/16	400	3/4"	UNF 1 1/16" -12	15,5	17	23,8	78,0	48	48	10,7	M 10 x 35	3/8" x 1.1/2"
WFG 6002 JIC 1 5/16	400	3/4"	UN 1.5/16" -12	21,5	17	23,8	78,0	48	48	10,7	M 10 x 35	3/8" x 1.1/2"
WFG 6002 JIC 7/8	400	3/4"	UNF 7/8" -14	12,3	17	23,8	78,0	48	48	10,7	M 10 x 35	3/8" x 1.1/2"
WFG 6003 JIC 1 1/16	400	1"	UNF 1 1/16" -12	15,5	24	27,8	99,0	60	60	*1	M 12 x 45	7/16" x 1.3/4"
WFG 6003 JIC 1 5/16	400	1"	UN 1.5/16" -12	21,5	24	27,8	99,0	60	60	*1	M 12 x 45	7/16" x 1.3/4"
WFG 6003 JIC 1 5/8	400	1"	UN 1.5/8" -12	27,5	24	27,8	99,0	60	60	*1	M 12 x 45	7/16" x 1.1/2"
WFG 6004 JIC 1 5/16	400	1.1/4"	UN 1.5/16" -12	21,5	30	31,8	115,5	68	68	*2	M 14 x 50	1/2" x 1.3/4"
WFG 6004 JIC 1 5/8	400	1.1/4"	UN 1.5/8" -12	27,5	30	31,8	115,5	68	68	*2	M 14 x 50	1/2" x 1.3/4"
WFG 6004 JIC 1 7/8	400	1.1/4"	UN 1.7/8" -12	33,0	30	31,8	115,5	68	68	*2	M 14 x 50	1/2" x 1.3/4"
WFG 6005 JIC 1 5/8	400	1.1/2"	UN 1.5/8" -12	27,5	32	36,5	133,0	76	76	17,0	M 16 x 55	5/8" x 2"
WFG 6005 JIC 1 7/8	400	1.1/2"	UN 1.7/8" -12	33,0	32	36,5	133,0	76	76	17,0	M 16 x 55	5/8" x 2"

PN = Nominal pressure PB = Max. operating pressure

*1) = Choice of 12.0 or 12.5 - *2) = Choice of 13.5 or 14.5

Product versions

WFG JIC U (3000 / 6000 PSI)	SAE flange adapter, forged, with 2 flange halves, screw set and O-ring
WFG JIC M (3000 / 6000 PSI)	SAE flange adapter, forged, with 2 flange halves, screw set and O-ring