

WFG JIC U (3000 / 6000 PSI)

SAE flange adapter, forged

HANSA FLEX

Properties

Standard	SAE J 518 C ISO 6162
Construction type	forged
Construction	Angle 90°
Design	SAE flange adapter
Scope of supply	with 2 flange halves, screw set and O-ring
Material	S355J2G3 (ST52.3)
Surface	electro galvanised

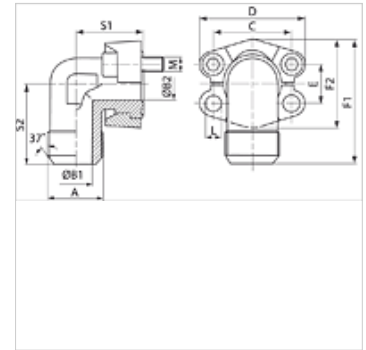

Note

The stated maximum working pressure relates to the flange. The actual working pressure is determined by the pipe (wall thickness) and the quality of the pipe.

Item

Identification	Pressure series	PB 10.9 (bar)	Size	A	B1	B2	C	D	E	F1	F2	S1	S2	L	Screws
					(mm)	(mm)	(mm)	(mm)	(mm)	(mm)	(mm)	(mm)	(mm)	(mm)	
WFG 3001 JIC 3/4 U	3000 PSI	350	1/2"	UNF 3/4" -16	9,9	13	38,1	54	17,5	60,8	45,6	38	38	8,7	(4 x) UNC 5/16 x 1.1/4
WFG 3001 JIC 7/8 U	3000 PSI	350	1/2"	UNF 7/8" -14	12,3	13	38,1	54	17,5	60,8	45,6	38	38	8,7	(4 x) UNC 5/16 x 1.1/4
WFG 3002 JIC 1 1/16 U	3000 PSI	350	3/4"	UNF 1 1/16" -12	15,5	19	47,6	65	22,2	70,9	51,8	42	45	10,7	(4 x) UNC 3/8 x 1.1/2
WFG 3002 JIC 1 5/16 U	3000 PSI	350	3/4"	UN 1.5/16" -12	21,5	19	47,6	65	22,2	70,9	51,8	42	45	10,7	(4 x) UNC 3/8 x 1.1/2
WFG 3002 JIC 7/8 U	3000 PSI	350	3/4"	UNF 7/8" -14	12,3	19	47,6	65	22,2	70,9	51,8	42	45	10,7	(4 x) UNC 3/8 x 1.1/2
WFG 3003 JIC 1 1/16 U	3000 PSI	315	1"	UNF 1 1/16" -12	15,5	24	52,4	70	26,2	79,2	58,4	45	50	10,7	(4 x) UNC 3/8 x 1.1/2
WFG 3003 JIC 1 5/16 U	3000 PSI	315	1"	UN 1.5/16" -12	21,5	24	52,4	70	26,2	79,2	58,4	45	50	10,7	(4 x) UNC 3/8 x 1.1/2
WFG 3003 JIC 1 5/8 U	3000 PSI	315	1"	UN 1.5/8" -12	27,5	24	52,4	70	26,2	79,2	58,4	45	50	10,7	(4 x) UNC 3/8 x 1.1/2
WFG 3004 JIC 1 5/16 U	3000 PSI	250	1.1/4"	UN 1.5/16" -12	21,5	31	58,7	79	30,2	85,3	72,6	50	59	*1	(4 x) UNC 7/16 x 1.1/2
WFG 3004 JIC 1 5/8 U	3000 PSI	250	1.1/4"	UN 1.5/8" -12	27,5	31	58,7	79	30,2	85,3	72,6	50	59	*1	(4 x) UNC 7/16 x 1.1/2
WFG 3005 JIC 1 5/8 U	3000 PSI	200	1.1/2"	UN 1.5/8" -12	27,5	38	69,9	94	35,7	117,1	82,2	76	76	13,5	(4 x) UNC 1/2 x 1.3/4
WFG 3005 JIC 1 7/8 U	3000 PSI	200	1.1/2"	UN 1.7/8" -12	33,0	38	69,9	94	35,7	117,1	82,2	76	76	13,5	(4 x) UNC 1/2 x 1.3/4
WFG 6001 JIC 3/4 U	6000 PSI	400	1/2"	UNF 3/4" -16	9,9	13	40,5	56	18,2	61,6	47,2	39	38	8,7	(4 x) UNC 5/16 x 1.1/4
WFG 6001 JIC 7/8 U	6000 PSI	400	1/2"	UNF 7/8" -14	12,3	13	40,5	56	18,2	61,6	47,2	39	38	8,7	(4 x) UNC 5/16 x 1.1/4
WFG 6002 JIC 1 1/16 U	6000 PSI	400	3/4"	UNF 1 1/16" -12	15,5	17	50,8	71	23,8	78,0	60,0	48	48	10,7	(4 x) UNC 3/8 x 1.1/2
WFG 6002 JIC 1 5/16 U	6000 PSI	400	3/4"	UN 1.5/16" -12	21,5	17	50,8	71	23,8	78,0	60,0	48	48	10,7	(4 x) UNC 3/8 x 1.1/2
WFG 6002 JIC 7/8 U	6000 PSI	400	3/4"	UNF 7/8" -14	12,3	17	50,8	71	23,8	78,0	60,0	48	48	10,7	(4 x) UNC 3/8 x 1.1/2
WFG 6003 JIC 1 1/16 U	6000 PSI	400	1"	UNF 1 1/16" -12	15,5	24	57,2	81	27,8	99,0	69,9	60	60	*2	(4 x) UNC 7/16 x 1.3/4
WFG 6003 JIC 1 5/16 U	6000 PSI	400	1"	UN 1.5/16" -12	21,5	24	57,2	81	27,8	99,0	69,9	60	60	*2	(4 x) UNC 7/16 x 1.3/4
WFG 6003 JIC 1 5/8 U	6000 PSI	400	1"	UN 1.5/8" -12	27,5	24	57,2	81	27,8	99,0	69,9	60	60	*2	(4 x) UNC 7/16 x 1.3/4
WFG 6004 JIC 1 5/16 U	6000 PSI	400	1.1/4"	UN 1.5/16" -12	21,5	30	66,7	95	31,8	115,5	77,2	68	68	*3	(4 x) UNC 1/2 x 1.3/4
WFG 6004 JIC 1 5/8 U	6000 PSI	400	1.1/4"	UN 1.5/8" -12	27,5	30	66,7	95	31,8	115,5	77,2	68	68	*3	(4 x) UNC 1/2 x 1.3/4
WFG 6004 JIC 1 7/8 U	6000 PSI	400	1.1/4"	UN 1.7/8" -12	33,0	30	66,7	95	31,8	115,5	77,2	68	68	*3	(4 x) UNC 1/2 x 1.3/4
WFG 6005 JIC 1 5/8 U	6000 PSI	400	1.1/2"	UN 1.5/8" -12	27,5	32	79,4	113	36,5	133,0	95,0	76	76	17,0	(4 x) UNC 5/8 x 2
WFG 6005 JIC 1 7/8 U	6000 PSI	400	1.1/2"	UN 1.7/8" -12	33,0	32	79,4	113	36,5	133,0	95,0	76	76	17,0	(4 x) UNC 5/8 x 2

Series: LL = Very light L = Light S = Heavy - Ø = External pipe diameter - PN = Nominal pressure PB = Max. operating pressure

*1) = Choice of 10.5, 12.0 or 12.5 - *2) = Choice of 12.0 or 12.5 - *3) = Choice of 13.5 or 14.5

Product versions

WFG JIC (6000 PSI)	SAE flange adapter, forged, flange only
WFG JIC M (3000 / 6000 PSI)	SAE flange adapter, forged, with 2 flange halves, screw set and O-ring