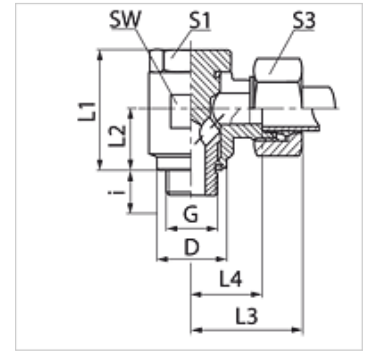

Properties

Connection 1	metric cylindrical outer thread
Sealing form 1	Edge sealing ring
Connection 2	metric cylindrical outer thread
Sealing form 2	24° inner cone
Design	Banjo coupling, throttle free
Construction	Angle 90°
Standard	DIN 2353 ISO 8434-1
Scope of supply	Socket with union nut and cutting ring
Material	Steel
Surface	electro galvanised

Note

Information about fitting, installation, pressure loads and permissible operating temperatures can be found in the technical information for pipe fittings.

Item

Identification	Series	Operating pressure	External pipe Ø	G	D	i	L1	L2	L3	L4	AF	S1	S3
				(mm)	(mm)	(mm)	(mm)	(mm)	(mm)	(mm)	(mm)	(mm)	(mm)
SDM NW 04 HL	L	PN 250	6	M 10 x 1	14	8	24,0	10,5	27	12,0	17	17	14
SDM NW 06 HL	L	PN 250	8	M 12 x 1.5	17	12	30,0	14,0	29	14,5	22	19	17
SDM NW 08 HL	L	PN 250	10	M 14 x 1.5	19	12	30,0	14,0	30	15,5	22	19	19
SDM NW 10 HL	L	PN 250	12	M 16 x 1.5	21	12	36,0	16,5	33	18,0	27	24	22
SDM NW 10 HL 18	L	PN 250	12	M 18 x 1.5	23	12	38,0	17,0	33	13,5	30	27	22
SDM NW 13 HL	L	PN 250	15	M 18 x 1.5	23	12	39,5	18,5	36	20,5	30	27	27
SDM NW 16 HL	L	PN 250	18	M 22 x 1.5	27	14	45,0	21,5	37	21,0	32	30	32
SDM NW 20 HL	L	PN 160	22	M 26 x 1.5	31	16	53,0	24,0	44	27,5	41	36	36
SDM NW 25 HL	L	PN 160	28	M 33 x 2	39	18	66,0	30,5	49	32,0	50	46	41
SDM NW 32 HL	L	PN 160	35	M 42 x 2	49	20	76,0	35,5	58	36,0	60	55	50
SDM NW 40 HL	L	PN 160	42	M 48 x 2	55	22	87,0	40,5	63	40,5	70	60	60
SDM NW 03 HS	S	PN 315	6	M 12 x 1.5	17	12	30,0	14,0	31	16,5	22	19	17
SDM NW 04 HS	S	PN 315	8	M 14 x 1.5	19	12	30,0	14,0	31	16,5	22	19	19
SDM NW 06 HS	S	PN 315	10	M 16 x 1.5	21	12	36,0	16,5	35	18,5	27	24	22
SDM NW 08 HS	S	PN 315	12	M 18 x 1.5	23	12	39,5	18,5	36	20,0	30	27	24
SDM NW 10 HS	S	PN 315	14	M 20 x 1.5	25	14	43,5	20,0	40	22,5	32	30	27
SDM NW 13 HS	S	PN 315	16	M 22 x 1.5	27	14	45,0	21,5	40	22,0	32	30	30
SDM NW 16 HS	S	PN 160	20	M 27 x 2	32	16	53,0	24,0	48	26,5	41	36	36
SDM NW 20 HS	S	PN 160	25	M 33 x 2	39	18	66,0	30,5	56	31,5	50	46	46
SDM NW 25 HS	S	PN 160	30	M 42 x 2	49	20	76,0	35,5	64	37,0	60	55	50
SDM NW 32 HS	S	PN 160	38	M 48 x 2	55	22	87,0	40,5	72	41,5	70	60	60

PN = Nominal pressure PB = Max. operating pressure – Series: LL = Very light L = Light S = Heavy – Ø = External pipe diameter

Product versions

XSDM Banjo fitting, throttle free, angle 90°, Steel