

### Properties

<b>Connection 1</b>	metric cylindrical outer thread
<b>Sealing form 1</b>	Shape F
<b>Connection 2</b>	metric cylindrical outer thread
<b>Sealing form 2</b>	24° inner cone
<b>Design</b>	Banjo coupling, throttle free
<b>Construction</b>	Angle 90°
<b>Standard</b>	DIN 2353 ISO 8434-1
<b>Scope of supply</b>	Socket with union nut and cutting ring
<b>Material</b>	Steel
<b>Surface</b>	electro galvanised

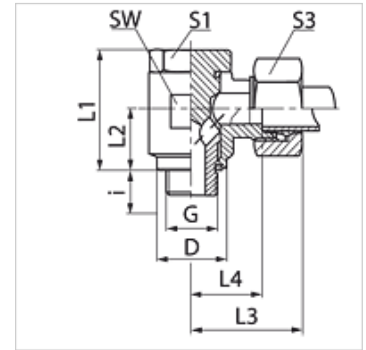

### Note

Information about fitting, installation, pressure loads and permissible operating temperatures can be found in the technical information for pipe fittings.

### Item

Identification	Series	Operating pressure	External pipe Ø (mm)	G	D (mm)	i (mm)	L1 (mm)	L2 (mm)	L3 (mm)	L4 (mm)	AF (mm)	S1	S3	OR
SDOM 06 LL	LL	PN 100	6	M 10 x 1	14,7	8,0	23,5	10,5	28,0	13,5	17	17	12	7.65 x 1.78
SDOM 08 LL	LL	PN 100	8	M 10 x 1	14,7	8,0	23,5	10,5	28,0	13,5	17	17	14	7.65 x 1.78
SDOM NW 04 HL	L	PN 315	6	M 10 x 1	14,0	8,0	24,0	10,5	27,0	12,0	17	17	14	7.65 x 1.78
SDOM NW 06 HL	L	PN 315	8	M 12 x 1.5	17,0	12,0	30,0	14,0	29,0	14,5	22	19	17	11.10 x 1.78
SDOM NW 08 HL	L	PN 315	10	M 14 x 1.5	19,0	12,0	30,0	14,0	30,0	15,5	22	19	19	11.10 x 1.78
SDOM NW 10 HL	L	PN 315	12	M 16 x 1.5	21,0	12,0	36,0	16,5	33,0	18,0	27	24	22	14.00 x 1.78
SDOM NW 10 HL 18	L	PN 315	12	M 18 x 1.5	23,5	12,0	35,0	16,5	33,0	18,0	27	24	22	18.77 x 1.78
SDOM NW 13 HL	L	PN 315	15	M 18 x 1.5	23,0	12,0	39,5	18,5	37,0	21,5	30	27	27	18.77 x 1.78
SDOM NW 16 HL	L	PN 315	18	M 22 x 1.5	27,0	14,0	45,0	21,5	37,0	21,0	32	30	32	18.77 x 1.78
SDOM NW 20 HL	L	PN 160	22	M 26 x 1.5	31,0	16,0	53,0	24,0	44,0	27,5	41	36	36	23.81 x 2.62
SDOM NW 25 HL	L	PN 160	28	M 33 x 2	39,0	18,0	66,0	30,5	49,0	32,0	50	46	41	29.82 x 2.62
SDOM NW 32 HL	L	PN 160	35	M 42 x 2	49,0	20,0	76,0	35,5	58,0	36,0	60	55	50	37.77 x 2.62
SDOM NW 40 HL	L	PN 160	42	M 48 x 2	55,0	22,0	87,0	40,5	63,0	40,5	70	60	60	41.28 x 3.53
SDOM NW 03 HS	S	PN 400	6	M 12 x 1.5	17,0	12,0	30,0	14,0	31,0	16,5	22	19	17	11.10 x 1.78
SDOM NW 04 HS	S	PN 400	8	M 14 x 1.5	19,0	12,0	30,0	14,0	31,0	16,5	22	19	19	11.10 x 1.78
SDOM NW 06 HS	S	PN 400	10	M 16 x 1.5	21,0	12,0	35,0	16,5	35,0	18,5	27	24	22	14.00 x 1.78
SDOM NW 08 HS	S	PN 400	12	M 18 x 1.5	23,0	12,0	39,5	18,5	36,0	20,0	30	27	24	18.77 x 1.78
SDOM NW 10 HS	S	PN 400	14	M 20 x 1.5	25,0	14,0	43,5	20,0	40,0	22,5	32	30	27	18.77 x 1.78
SDOM NW 13 HS	S	PN 315	16	M 22 x 1.5	27,0	14,0	45,0	21,5	40,0	22,0	32	30	30	18.77 x 1.78
SDOM NW 16 HS	S	PN 315	20	M 27 x 2	32,0	16,0	53,0	24,0	48,0	26,5	41	36	36	23.81 x 2.62
SDOM NW 20 HS	S	PN 250	25	M 33 x 2	39,0	18,0	66,0	30,5	56,0	31,5	50	46	46	29.38 x 2.62
SDOM NW 25 HS	S	PN 160	30	M 42 x 2	49,0	20,0	76,0	35,5	64,0	37,0	60	55	50	37.77 x 2.62
SDOM NW 32 HS	S	PN 160	38	M 48 x 2	55,0	22,0	87,0	40,5	72,0	41,5	70	60	60	41.28 x 3.53

PN = Nominal pressure PB = Max. operating pressure - Series: LL = Very light L = Light S = Heavy - Ø = External pipe diameter

### Product versions

<b>SDOM VA</b>	Banjo fitting, throttle free, angle 90°, Stainless steel
<b>XSDOM</b>	Banjo fitting, throttle free, angle 90°, Steel