

SDOM VA

Banjo fitting, throttle free, angle 90°

HANSA FLEX

Properties

| | |
|------------------------|--|
| Connection 1 | metric cylindrical outer thread |
| Sealing form 1 | Shape F |
| Connection 2 | metric cylindrical outer thread |
| Sealing form 2 | 24° inner cone |
| Design | Banjo coupling, throttle free |
| Construction | Angle 90° |
| Standard | DIN 2353 ISO 8434-1 |
| Scope of supply | Socket with union nut and cutting ring |
| Material | Stainless steel |

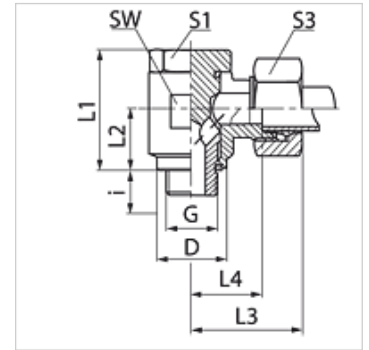

Ordering information

Seals of NBR

FPM (Viton) on request

Item

| Identification | Series | Operating pressure | External pipe Ø (mm) | G | D (mm) | i (mm) | L1 (mm) | L2 (mm) | L3 (mm) | L4 (mm) | AF (mm) | S1 | S3 | OR |
|------------------|--------|--------------------|----------------------|------------|--------|--------|---------|---------|---------|---------|---------|----|----|--------------|
| SDOM 04 LL VA | LL | PN 100 | 4 | M 8 x 1 | 14,7 | 8,0 | 23,5 | 10,5 | 29,0 | 11,0 | 18 | 17 | 10 | 6.10 x 1.60 |
| SDOM 06 LL VA | LL | PN 100 | 6 | M 10 x 1 | 14,7 | 8,0 | 23,5 | 10,5 | 28,0 | 13,5 | 17 | 17 | 12 | 7.65 x 1.78 |
| SDOM 08 LL VA | LL | PN 100 | 8 | M 10 x 1 | 14,7 | 8,0 | 23,5 | 10,5 | 28,0 | 13,5 | 17 | 17 | 14 | 7.65 x 1.78 |
| SDOM NW 04 HL VA | L | PN 315 | 6 | M 10 x 1 | 14,7 | 8,0 | 23,5 | 10,5 | 27,0 | 12,0 | 17 | 17 | 14 | 7.65 x 1.78 |
| SDOM NW 06 HL VA | L | PN 315 | 8 | M 12 x 1.5 | 17,7 | 12,5 | 29,5 | 14,0 | 29,5 | 14,5 | 22 | 19 | 17 | 11.10 x 1.78 |
| SDOM NW 08 HL VA | L | PN 315 | 10 | M 14 x 1.5 | 18,7 | 12,0 | 30,0 | 14,0 | 30,5 | 15,5 | 22 | 19 | 19 | 11.10 x 1.78 |
| SDOM NW 10 HL VA | L | PN 315 | 12 | M 16 x 1.5 | 22,7 | 12,0 | 35,0 | 16,5 | 33,0 | 18,0 | 27 | 24 | 22 | 14.00 x 1.78 |
| SDOM NW 13 HL VA | L | PN 315 | 15 | M 18 x 1.5 | 23,7 | 12,0 | 46,0 | 21,5 | 36,5 | 21,5 | 32 | 27 | 27 | 18.77 x 1.78 |
| SDOM NW 16 HL VA | L | PN 315 | 18 | M 22 x 1.5 | 27,7 | 11,4 | 46,7 | 21,5 | 38,0 | 21,0 | 32 | 27 | 32 | 18.77 x 1.78 |
| SDOM NW 20 HL VA | L | PN 160 | 22 | M 26 x 1.5 | 32,7 | 16,0 | 52,0 | 24,0 | 44,0 | 27,5 | 41 | 36 | 36 | 23.81 x 2.62 |
| SDOM NW 25 HL VA | L | PN 160 | 28 | M 33 x 2 | 39,7 | 18,0 | 64,0 | 30,5 | 48,5 | 32,0 | 50 | 46 | 41 | 29.82 x 2.62 |
| SDOM NW 32 HL VA | L | PN 160 | 35 | M 42 x 2 | 49,7 | 20,0 | 75,0 | 35,5 | 57,5 | 36,0 | 60 | 50 | 50 | 37.77 x 2.62 |
| SDOM NW 40 HL VA | L | PN 160 | 42 | M 48 x 2 | 55,7 | 22,0 | 88,0 | 40,5 | 62,0 | 38,5 | 70 | 60 | 60 | 41.28 x 3.53 |
| SDOM NW 03 HS VA | S | PN 400 | 6 | M 12 x 1.5 | 17,7 | 12,0 | 30,0 | 14,0 | 31,5 | 16,5 | 22 | 19 | 17 | 11.10 x 1.78 |
| SDOM NW 04 HS VA | S | PN 400 | 8 | M 14 x 1.5 | 18,7 | 12,0 | 30,0 | 14,0 | 30,0 | 14,5 | 22 | 19 | 19 | 11.10 x 1.78 |
| SDOM NW 06 HS VA | S | PN 400 | 10 | M 16 x 1.5 | 22,7 | 12,0 | 35,0 | 16,5 | 35,0 | 18,5 | 27 | 24 | 22 | 14.00 x 1.78 |
| SDOM NW 08 HS VA | S | PN 400 | 12 | M 18 x 1.5 | 23,7 | 12,0 | 35,0 | 16,5 | 35,0 | 18,5 | 27 | 24 | 24 | 18.77 x 1.78 |
| SDOM NW 10 HS VA | S | PN 400 | 14 | M 20 x 1.5 | 25,7 | 14,0 | 46,0 | 21,5 | 40,5 | 22,5 | 32 | 27 | 27 | 18.77 x 1.78 |
| SDOM NW 13 HS VA | S | PN 315 | 16 | M 22 x 1.5 | 27,7 | 14,0 | 46,0 | 21,5 | 41,0 | 22,5 | 32 | 27 | 30 | 18.77 x 1.78 |
| SDOM NW 16 HS VA | S | PN 315 | 20 | M 27 x 2 | 32,7 | 16,0 | 52,0 | 24,0 | 48,0 | 26,5 | 41 | 36 | 36 | 23.81 x 2.62 |
| SDOM NW 20 HS VA | S | PN 250 | 25 | M 33 x 2 | 39,7 | 18,0 | 64,0 | 30,5 | 55,5 | 31,5 | 50 | 46 | 46 | 29.82 x 2.62 |
| SDOM NW 25 HS VA | S | PN 160 | 30 | M 42 x 2 | 49,7 | 20,0 | 75,0 | 35,5 | 63,5 | 37,0 | 60 | 50 | 50 | 37.77 x 2.62 |
| SDOM NW 32 HS VA | S | PN 160 | 38 | M 48 x 2 | 55,7 | 23,0 | 87,0 | 40,5 | 72,5 | 41,5 | 70 | 60 | 60 | 41.28 x 3.53 |

Series: LL = Very light L = Light S = Heavy - PN = Nominal pressure PB = Max. operating pressure - Ø = External pipe diameter

Product versions

SDOM Banjo fitting, throttle free, angle 90°, Steel

XSDOM Banjo fitting, throttle free, angle 90°, Steel