

Properties

Connection 1	BSP external thread, cylindrical
Sealing form 1	Edge sealing ring
Connection 2	metric cylindrical outer thread
Sealing form 2	24° inner cone
Design	Banjo fitting
Construction	Angle 90°
Standard	DIN 2353 ISO 8434-1
Scope of supply	Socket with union nut and cutting ring
Material	Steel
Surface	electro galvanised

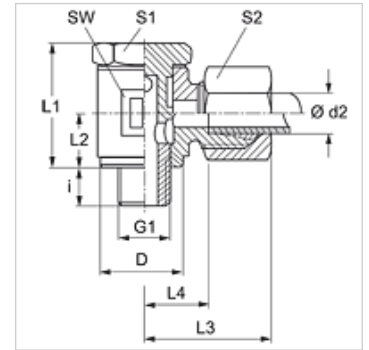

Note

Information about fitting, installation, pressure loads and permissible operating temperatures can be found in the technical information for pipe fittings.

Item

Identification	Series	Operating pressure	Ø d2 (mm)	G1	D (mm)	i (mm)	L1 (mm)	L2 (mm)	L3 (mm)	L4 (mm)	AF (mm)	S1	S2
SWR 04 LL	LL	PN 100	4	G 1/8" -28	14,5	6	21,5	10	20	13,0	14	14	10
SWR 05 LL	LL	PN 100	5	G 1/8" -28	14,5	6	21,5	10	20	11,5	14	14	12
SWR 06 LL	LL	PN 100	6	G 1/8" -28	14,5	6	21,5	10	20	11,5	14	14	12
SWR 08 LL	LL	PN 100	8	G 1/8" -28	14,5	6	21,5	10	21	12,5	14	14	14
SWR NW 13 HL 3/8	L	PN 250	15	G 3/8" -19	24,0	9	45,0	22	34	19,5	30	27	27
SWR NW 16 HL	L	PN 160	18	G 1/2" -14	26,0	11	44,0	21	36	19,5	30	27	32

Series: LL = Very light L = Light S = Heavy – PN = Nominal pressure PB = Max. operating pressure – Ø d2 = External pipe diameter

Product versions

SWR VA	Banjo fitting, angle 90°, Stainless steel
XSWR	Banjo fitting, angle 90°, Steel