

VEV VA

Fitting, angle 90°

Properties

Connection 1	metric nut thread
Sealing form 1	Pipe socket with cutting ring
Connection 2	metric cylindrical outer thread
Sealing form 2	24° inner cone
Design	Adjustable direction fitting
Construction	Angle 90°
Standard	DIN 2353 ISO 8434-1
Scope of supply	Socket with union nut and cutting ring
Material	Stainless steel

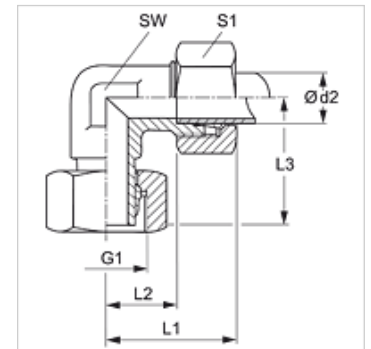

Note

Information about fitting, installation, pressure loads and permissible operating temperatures can be found in the technical information for pipe fittings.

Item

Identification	Series	Operating pressure	$\varnothing d2$ (mm)	G1	L1 (mm)	L2 (mm)	L3 (mm)	AF (mm)	S1
VEV NW 04 HL VA	L	PN 315	6	M 12 x 1.5	27	12,0	26,0	12	14
VEV NW 06 HL VA	L	PN 315	8	M 14 x 1.5	29	14,0	27,5	12	17
VEV NW 08 HL VA	L	PN 315	10	M 16 x 1.5	30	15,0	29,0	14	19
VEV NW 10 HL VA	L	PN 315	12	M 18 x 1.5	32	17,0	29,5	17	22
VEV NW 13 HL VA	L	PN 315	15	M 22 x 1.5	36	21,0	32,5	19	27
VEV NW 16 HL VA	L	PN 315	18	M 26 x 1.5	40	23,5	35,5	24	32
VEV NW 20 HL VA	L	PN 160	22	M 30 x 2	44	27,5	38,0	27	36
VEV NW 25 HL VA	L	PN 160	28	M 36 x 2	47	30,5	41,5	36	41
VEV NW 32 HL VA	L	PN 160	35	M 45 x 2	56	34,5	51,0	41	50
VEV NW 40 HL VA	L	PN 160	42	M 52 x 2	63	40,0	56,0	50	60
VEV NW 03 HS VA	S	PN 630	6	M 14 x 1.5	31	16,0	27,0	12	17
VEV NW 04 HS VA	S	PN 630	8	M 16 x 1.5	32	17,0	27,5	14	19
VEV NW 06 HS VA	S	PN 630	10	M 18 x 1.5	34	17,5	29,5	17	22
VEV NW 08 HS VA	S	PN 630	12	M 20 x 1.5	38	21,5	30,5	17	24
VEV NW 10 HS VA	S	PN 630	14	M 22 x 1.5	40	22,0	35,0	19	27
VEV NW 13 HS VA	S	PN 400	16	M 24 x 1.5	43	24,5	36,5	24	30
VEV NW 16 HS VA	S	PN 400	20	M 30 x 2	48	26,5	44,5	27	36
VEV NW 20 HS VA	S	PN 400	25	M 36 x 2	54	30,0	49,5	36	46
VEV NW 25 HS VA	S	PN 400	30	M 42 x 2	62	35,5	55,0	41	50
VEV NW 32 HS VA	S	PN 315	38	M 52 x 2	72	41,0	63,0	50	60

Series: LL = Very light L = Light S = Heavy - PN = Nominal pressure PB = Max. operating pressure - $\varnothing d2$ = External pipe diameter

Product versions

VEV	Fitting, angle 90°, Steel
VEV MG	Fitting, angle 90°, Brass
XVEV VA	Fitting, angle 90°, Stainless steel