

Properties

| | |
|------------------------|--|
| Connection 1 | BSPT conical external threads |
| Sealing form 1 | thread seal |
| Connection 2 | metric cylindrical outer thread |
| Sealing form 2 | 24° inner cone |
| Design | Screw-in fitting |
| Construction | Angle 90° |
| Standard | DIN 2353 ISO 8434-1 |
| Scope of supply | Socket with union nut and cutting ring |
| Material | Brass |

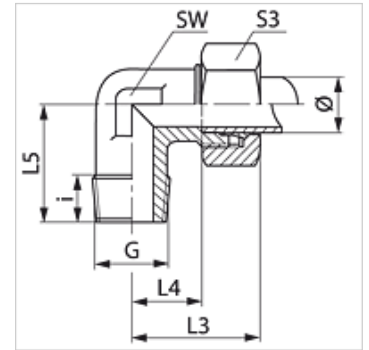

Note

Information about fitting, installation, pressure loads and permissible operating temperatures can be found in the technical information for pipe fittings.

Item

| Identification | Series | Operating pressure | External pipe Ø (mm) | G | i (mm) | L3 (mm) | L4 (mm) | L5 (mm) | AF (mm) | S3 |
|--------------------|--------|--------------------|----------------------|----------|--------|---------|---------|---------|---------|----|
| WR 04 LL MG | LL | PN 63 | 4 | R 1/8" K | 8 | 21 | 11,0 | 18 | 11 | 10 |
| WR 05 LL MG | LL | PN 63 | 5 | R 1/8" K | 8 | 22 | 10,0 | 17 | 11 | 12 |
| WR 06 LL MG | LL | PN 63 | 6 | R 1/8" K | 8 | 22 | 10,0 | 17 | 11 | 12 |
| WR 08 LL MG | LL | PN 63 | 8 | R 1/8" K | 8 | 23 | 11,5 | 20 | 12 | 14 |
| WR 10 LL MG | LL | PN 63 | 10 | R 1/4" K | 12 | 27 | 15,5 | 26 | 14 | 17 |
| WR 12 LL MG | LL | PN 63 | 12 | R 1/4" K | 12 | 27 | 15,0 | 27 | 17 | 19 |
| WR NW 04 HL MG | L | PN 200 | 6 | R 1/8" K | 8 | 27 | 12,0 | 20 | 12 | 14 |
| WR NW 04 HL 1/4 MG | L | PN 200 | 6 | R 1/4" K | 12 | 29 | 14,0 | 26 | 12 | 14 |
| WR NW 06 HL MG | L | PN 200 | 8 | R 1/4" K | 12 | 29 | 14,0 | 26 | 12 | 17 |
| WR NW 08 HL MG | L | PN 200 | 10 | R 1/4" K | 12 | 30 | 15,0 | 27 | 14 | 19 |
| WR NW 10 HL MG | L | PN 200 | 12 | R 3/8" K | 12 | 32 | 17,0 | 28 | 17 | 22 |
| WR NW 10 HL 1/4 MG | L | PN 200 | 12 | R 1/4" K | 12 | 32 | 17,0 | 28 | 17 | 22 |
| WR NW 10 HL 1/2 MG | L | PN 200 | 12 | R 1/2" K | 14 | 38 | 23,0 | 34 | 19 | 22 |
| WR NW 13 HL MG | L | PN 200 | 15 | R 1/2" K | 14 | 36 | 21,0 | 34 | 19 | 27 |
| WR NW 16 HL MG | L | PN 200 | 18 | R 1/2" K | 14 | 40 | 23,5 | 36 | 24 | 32 |
| WR NW 03 HS MG | S | PN 250 | 6 | R 1/4" K | 12 | 31 | 16,0 | 26 | 12 | 17 |
| WR NW 04 HS MG | S | PN 250 | 8 | R 1/4" K | 12 | 32 | 17,0 | 27 | 17 | 19 |
| WR NW 06 HS MG | S | PN 250 | 10 | R 3/8" K | 12 | 34 | 17,5 | 28 | 17 | 22 |
| WR NW 13 HS MG | S | PN 250 | 16 | R 1/2" K | 14 | 43 | 24,5 | 32 | 24 | 30 |

Series: LL = Very light L = Light S = Heavy - PN = Nominal pressure PB = Max. operating pressure - Ø = External pipe diameter

Product versions

| | |
|---------------|--|
| WRK | Screw-in fitting, angle 90°, Steel |
| WRK VA | Screw-in fitting, angle 90°, Stainless steel |