

XDWM

Banjo fitting, throttle free, angle 90°

HANSA FLEX

Properties

Connection 1	metric cylindrical outer thread
Sealing form 1	Edge sealing ring
Connection 2	metric cylindrical outer thread
Sealing form 2	24° inner cone
Design	Banjo coupling, throttle free
Construction	Angle 90°
Standard	DIN 2353 ISO 8434-1
Scope of supply	Socket (without union nut and cutting ring)
Material	Steel
Surface	electro galvanised

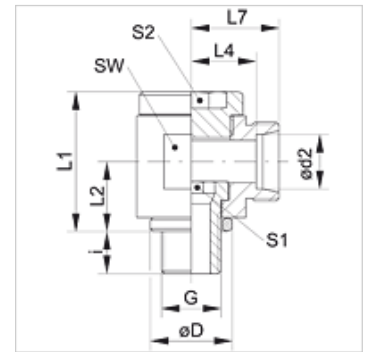

Note

Information about fitting, installation, pressure loads and permissible operating temperatures can be found in the technical information for pipe fittings.

Item

Identification	Series	Operating pressure	Ø d2 (mm)	G	Ø D (mm)	i (mm)	L1 (mm)	L2 (mm)	L4 (mm)	L7 (mm)	AF (mm)	S1	S2
XDWM NW 04 HL	L	PN 160	6	M 10 x 1	14	8	24	12	12,5	19	19	6	6
XDWM NW 06 HL	L	PN 160	8	M 12 x 1.5	17	12	30	15	14,5	21	22	6	6
XDWM NW 08 HL	L	PN 100	10	M 14 x 1.5	19	12	30	16	15,5	22	22	8	8
XDWM NW 10 HL	L	PN 100	12	M 16 x 1.5	21	12	37	18	18,0	25	27	10	10
XDWM NW 10 HL 18	L	PN 100	12	M 18 x 1.5	23	12	37	18	18,0	25	30	12	12
XDWM NW 13 HL	L	PN 100	15	M 18 x 1.5	23	12	40	20	22,0	26	30	12	12
XDWM NW 16 HL	L	PN 100	18	M 22 x 1.5	27	14	46	23	21,5	27	36	14	14
XDWM NW 20 HL	L	PN 100	22	M 26 x 1.5	31	16	51	25	26,0	33	41	17	17
XDWM NW 25 HL	L	PN 100	28	M 33 x 2	39	18	64	32	31,5	39	50	22	22
XDWM NW 32 HL	L	PN 63	35	M 42 x 2	49	20	76	37	35,5	46	60	27	27
XDWM NW 40 HL	L	PN 63	42	M 48 x 2	55	22	85	42	40,0	51	70	32	32
XDWM NW 03 HS	S	PN 160	6	M 12 x 1.5	17	12	30	15	16,5	23	22	6	6
XDWM NW 04 HS	S	PN 160	8	M 14 x 1.5	19	12	30	16	16,5	23	22	8	8
XDWM NW 06 HS	S	PN 100	10	M 16 x 1.5	21	12	37	18	18,5	26	27	10	10
XDWM NW 08 HS	S	PN 100	12	M 18 x 1.5	23	12	41	20	20,5	28	30	12	12
XDWM NW 10 HS	S	PN 100	14	M 20 x 1.5	25	14	42	21	23,0	31	32	12	12
XDWM NW 13 HS	S	PN 100	16	M 22 x 1.5	27	14	46	23	22,5	31	36	14	14
XDWM NW 16 HS	S	PN 100	20	M 27 x 2	32	16	58	28	27,5	38	46	17	17
XDWM NW 20 HS	S	PN 100	25	M 33 x 2	39	18	64	32	31,0	43	50	22	22
XDWM NW 25 HS	S	PN 63	30	M 42 x 2	49	20	76	37	36,5	50	60	27	27
XDWM NW 32 HS	S	PN 63	38	M 48 x 2	55	22	85	42	41,0	57	70	32	32

Series: LL = Very light L = Light S = Heavy - PN = Nominal pressure PB = Max. operating pressure - Ø d2 = External pipe diameter

Product versions

XDWM VA	Banjo fitting, throttle free, angle 90°, Socket (without union nut and cutting ring)
DWM	Banjo fitting, throttle free, angle 90°, Socket with union nut and cutting ring