

# XDWM VA

Banjo fitting, throttle free, angle 90°

**HANSA FLEX**

## Properties

<b>Connection 1</b>	metric cylindrical outer thread
<b>Sealing form 1</b>	Edge sealing ring
<b>Connection 2</b>	metric cylindrical outer thread
<b>Sealing form 2</b>	24° inner cone
<b>Design</b>	Banjo coupling, throttle free
<b>Construction</b>	Angle 90°
<b>Standard</b>	DIN 2353 ISO 8434-1
<b>Scope of supply</b>	Socket (without union nut and cutting ring)
<b>Material</b>	Stainless steel

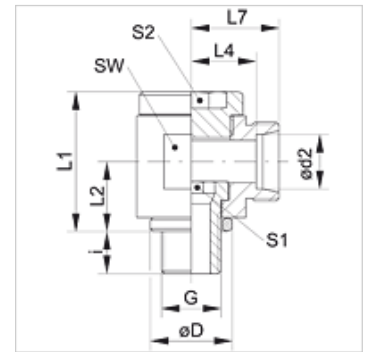

## Note

Information about fitting, installation, pressure loads and permissible operating temperatures can be found in the technical information for pipe fittings.

## Item

Identification	Series	Operating pressure	Ø d2 (mm)	G	Ø D (mm)	i (mm)	L1 (mm)	L2 (mm)	L4 (mm)	L7 (mm)	AF (mm)	S1	S2
XDWM NW 04 HL VA	L	PN 160	6	M 10 x 1	14	8	24	12	12,5	19	19	6	6
XDWM NW 06 HL VA	L	PN 160	8	M 12 x 1.5	17	12	30	15	14,5	21	22	6	6
XDWM NW 08 HL VA	L	PN 100	10	M 14 x 1.5	19	12	30	16	15,5	22	22	8	8
XDWM NW 10 HL VA	L	PN 100	12	M 16 x 1.5	21	12	37	18	18,0	25	27	10	10
XDWM NW 13 HL VA	L	PN 100	15	M 18 x 1.5	23	12	40	20	21,0	26	30	12	12
XDWM NW 16 HL VA	L	PN 100	18	M 22 x 1.5	27	14	46	23	21,5	29	36	14	14
XDWM NW 20 HL VA	L	PN 100	22	M 26 x 1.5	31	16	51	25	26,0	33	41	17	17
XDWM NW 25 HL VA	L	PN 100	28	M 33 x 2	39	18	64	32	31,5	39	50	22	22
XDWM NW 32 HL VA	L	PN 63	35	M 42 x 2	49	20	76	37	35,5	46	60	27	27
XDWM NW 40 HL VA	L	PN 63	42	M 48 x 2	55	22	85	42	40,0	51	65	32	32
XDWM NW 03 HS VA	S	PN 160	6	M 12 x 1.5	17	12	30	15	16,5	23	22	6	6
XDWM NW 04 HS VA	S	PN 160	8	M 14 x 1.5	19	12	30	16	16,5	23	22	8	8
XDWM NW 06 HS VA	S	PN 100	10	M 16 x 1.5	21	12	37	18	18,5	26	27	10	10
XDWM NW 08 HS VA	S	PN 100	12	M 18 x 1.5	23	12	41	20	20,5	28	30	12	12
XDWM NW 10 HS VA	S	PN 100	14	M 20 x 1.5	25	14	42	21	23,0	31	32	12	12
XDWM NW 13 HS VA	S	PN 100	16	M 22 x 1.5	27	14	46	23	22,5	31	36	14	14
XDWM NW 16 HS VA	S	PN 100	20	M 27 x 2	32	16	58	28	27,5	38	46	17	17

Series: LL = Very light L = Light S = Heavy – PN = Nominal pressure PB = Max. operating pressure – Ø d2 = External pipe diameter

## Product versions

<b>XDWM</b>	Banjo fitting, throttle free, angle 90°, Socket (without union nut and cutting ring)
<b>DWM VA</b>	Banjo fitting, throttle free, angle 90°, Socket with union nut and cutting ring