

XDWR

Banjo fitting, throttle free, angle 90°



Properties

Connection 1	BSP external thread, cylindrical
Sealing form 1	Edge sealing ring
Connection 2	metric cylindrical outer thread
Sealing form 2	24° inner cone
Design	Banjo coupling, throttle free
Construction	Angle 90°
Standard	DIN 2353 ISO 8434-1
Scope of supply	Socket (without union nut and cutting ring)
Material	Steel
Surface	electro galvanised

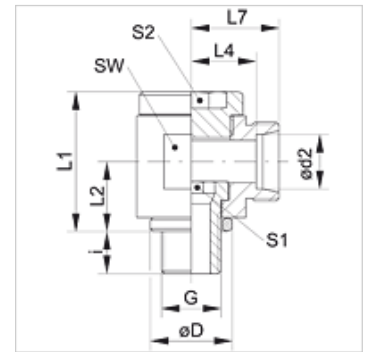

Note

Information about fitting, installation, pressure loads and permissible operating temperatures can be found in the technical information for pipe fittings.

Item

Identification	Series	Operating pressure	Ø d2 (mm)	G	Ø D (mm)	i (mm)	L1 (mm)	L2 (mm)	L4 (mm)	L7 (mm)	AF (mm)	S1	S2
XDWR NW 04 HL	L	PN 160	6	G 1/8" -28	14	8	24	12	12,5	19	19	6	6
XDWR NW 06 HL	L	PN 160	8	G 1/4" -19	18	12	30	16	14,5	21	22	8	8
XDWR NW 08 HL	L	PN 100	10	G 1/4" -19	18	12	30	16	15,5	22	22	8	8
XDWR NW 10 HL 1/4	L	PN 100	12	G 1/4" -19	18	12	37	18	15,5	22	22	8	8
XDWR NW 10 HL	L	PN 100	12	G 3/8" -19	22	12	37	18	18,0	25	27	10	10
XDWR NW 13 HL	L	PN 100	15	G 1/2" -14	26	14	42	21	22,0	29	32	12	12
XDWR NW 16 HL	L	PN 100	18	G 1/2" -14	26	14	46	23	21,5	29	36	12	12
XDWR NW 20 HL	L	PN 100	22	G 3/4" -14	32	16	58	28	28,5	36	46	17	17
XDWR NW 25 HL	L	PN 100	28	G 1" -11	39	18	64	32	31,5	39	50	22	22
XDWR NW 32 HL	L	PN 63	35	G 1.1/4" -11	49	20	76	37	35,5	46	60	27	27
XDWR NW 40 HL	L	PN 63	42	G 1.1/2" -11	55	22	85	42	40,0	51	70	32	32
XDWR NW 03 HS	S	PN 160	6	G 1/4" -19	18	12	30	16	16,5	23	22	8	8
XDWR NW 04 HS	S	PN 160	8	G 1/4" -19	18	12	30	16	16,5	23	22	8	8
XDWR NW 06 HS	S	PN 100	10	G 3/8" -19	22	12	37	18	18,5	26	27	10	10
XDWR NW 08 HS	S	PN 100	12	G 3/8" -19	22	12	37	18	18,5	26	27	10	10
XDWR NW 10 HS	S	PN 100	14	G 1/2" -14	26	14	42	21	23,0	31	32	12	12
XDWR NW 13 HS	S	PN 100	16	G 1/2" -14	26	14	46	23	22,5	31	36	12	12
XDWR NW 16 HS	S	PN 100	20	G 3/4" -14	32	16	58	28	27,5	38	46	17	17
XDWR NW 20 HS	S	PN 100	25	G 1" -11	39	18	64	32	31,0	43	50	22	22
XDWR NW 25 HS	S	PN 63	30	G 1.1/4" -11	49	20	76	37	36,5	50	60	27	27
XDWR NW 32 HS	S	PN 63	38	G 1.1/2" -11	55	22	85	42	41,0	57	70	32	32

Series: LL = Very light L = Light S = Heavy - PN = Nominal pressure PB = Max. operating pressure - Ø d2 = External pipe diameter

Product versions

XDWR VA	Banjo fitting, throttle free, angle 90°, Socket (without union nut and cutting ring)
DWR	Banjo fitting, throttle free, angle 90°, Socket with union nut and cutting ring