

XDWR VA

Banjo fitting, throttle free, angle 90°

HANSA FLEX

Properties

Connection 1	BSP external thread, cylindrical
Sealing form 1	Edge sealing ring
Connection 2	metric cylindrical outer thread
Sealing form 2	24° inner cone
Design	Banjo coupling, throttle free
Construction	Angle 90°
Standard	DIN 2353 ISO 8434-1
Scope of supply	Socket (without union nut and cutting ring)
Material	Stainless steel

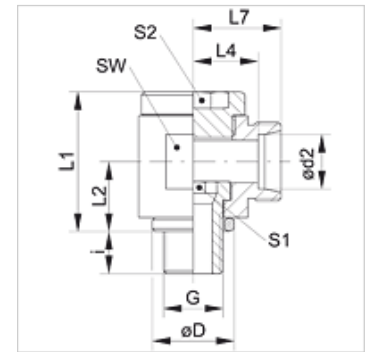

Note

Information about fitting, installation, pressure loads and permissible operating temperatures can be found in the technical information for pipe fittings.

Item

Identification	Series	Operating pressure	Ø d2 (mm)	G	Ø D (mm)	i (mm)	L1 (mm)	L2 (mm)	L4 (mm)	L7 (mm)	AF (mm)	S1	S2
XDWR NW 04 HL VA	L	PN 160	6	G 1/8" -28	14	8	24	12	12,5	19	19	6	6
XDWR NW 06 HL VA	L	PN 160	8	G 1/4" -19	18	12	30	16	14,5	21	22	8	8
XDWR NW 08 HL VA	L	PN 100	10	G 1/4" -19	18	12	30	16	15,5	22	22	8	8
XDWR NW 10 HL VA	L	PN 100	12	G 3/8" -19	22	12	37	18	18,0	25	27	10	10
XDWR NW 13 HL VA	L	PN 100	15	G 1/2" -14	26	14	42	21	22,0	29	32	12	12
XDWR NW 16 HL VA	L	PN 100	18	G 1/2" -14	26	14	46	23	21,5	29	36	12	12
XDWR NW 20 HL VA	L	PN 100	22	G 3/4" -14	32	16	58	28	28,5	36	46	17	17
XDWR NW 25 HL VA	L	PN 100	28	G 1" -11	39	18	64	32	31,5	39	50	22	22
XDWR NW 32 HL VA	L	PN 63	35	G 1.1/4" -11	49	20	76	37	35,5	46	60	27	27
XDWR NW 40 HL VA	L	PN 63	42	G 1.1/2" -11	55	22	85	42	40,0	51	65	32	32
XDWR NW 03 HS VA	S	PN 160	6	G 1/4" -19	18	12	30	16	16,5	23	22	8	8
XDWR NW 04 HS VA	S	PN 160	8	G 1/4" -19	18	12	30	16	16,5	23	22	8	8
XDWR NW 06 HS VA	S	PN 100	10	G 3/8" -19	22	12	37	18	18,5	27	27	10	10
XDWR NW 08 HS VA	S	PN 100	12	G 3/8" -19	22	12	37	18	18,5	27	27	10	10
XDWR NW 10 HS VA	S	PN 100	14	G 1/2" -14	26	14	42	21	23,0	31	32	12	12
XDWR NW 13 HS VA	S	PN 100	16	G 1/2" -14	26	14	46	23	22,5	31	36	12	12
XDWR NW 16 HS VA	S	PN 100	20	G 3/4" -14	32	16	58	28	27,5	38	46	17	17
XDWR NW 20 HS VA	S	PN 100	25	G 1" -11	39	18	64	32	31,0	43	50	22	22
XDWR NW 25 HS VA	S	PN 63	30	G 1.1/4" -11	49	20	76	37	36,5	50	60	27	27
XDWR NW 32 HS VA	S	PN 63	38	G 1.1/2" -11	55	22	85	42	41,0	57	70	32	32

Series: LL = Very light L = Light S = Heavy - PN = Nominal pressure PB = Max. operating pressure - Ø d2 = External pipe diameter

Product versions

XDWR	Banjo fitting, throttle free, angle 90°, Socket (without union nut and cutting ring)
DWR VA	Banjo fitting, throttle free, angle 90°, Socket with union nut and cutting ring