

XSDOM VA

Banjo fitting, throttle free, angle 90°

HANSA FLEX

Properties

| | |
|------------------------|---------------------------------------------|
| Connection 1 | metric cylindrical outer thread |
| Sealing form 1 | Shape E |
| Connection 2 | metric cylindrical outer thread |
| Sealing form 2 | 24° inner cone |
| Design | Banjo coupling, throttle free |
| Construction | Angle 90° |
| Standard | DIN 2353 ISO 8434-1 |
| Scope of supply | Socket (without union nut and cutting ring) |
| Material | Stainless steel |

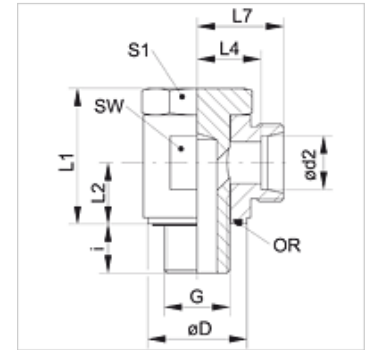

Note

Information about fitting, installation, pressure loads and permissible operating temperatures can be found in the technical information for pipe fittings.

Ordering information

Seals of NBR
FPM (Viton) on request

Item

| Identification | Series | Operating pressure | Ø d2 (mm) | G | Ø D (mm) | i (mm) | L1 (mm) | L2 (mm) | L4 (mm) | L7 (mm) | AF (mm) | S1 | OR |
|-------------------|--------|--------------------|-----------|------------|----------|--------|---------|---------|---------|---------|---------|----|--------------|
| XSDOM 04 LL VA | LL | PN 100 | 4 | M 8 x 1 | 12,5 | 8,0 | 23,5 | 10,5 | 13,5 | 19,0 | 18 | 17 | - |
| XSDOM 06 LL VA | LL | PN 100 | 6 | M 10 x 1 | 14,5 | 8,0 | 23,5 | 10,5 | 13,5 | 19,0 | 17 | 17 | 7.65 x 1.78 |
| XSDOM 08 LL VA | LL | PN 100 | 8 | M 10 x 1 | 14,5 | 8,0 | 23,5 | 10,5 | 13,5 | 19,0 | 17 | 17 | 7.65 x 1.78 |
| XSDOM NW 04 HL VA | L | PN 315 | 6 | M 10 x 1 | 14,5 | 8,0 | 23,5 | 10,5 | 12,0 | 19,0 | 17 | 17 | 7.65 x 1.78 |
| XSDOM NW 06 HL VA | L | PN 315 | 8 | M 12 x 1.5 | 17,5 | 12,5 | 29,5 | 14,0 | 14,5 | 21,5 | 22 | 19 | 11.10 x 1.78 |
| XSDOM NW 08 HL VA | L | PN 315 | 10 | M 14 x 1.5 | 18,5 | 12,0 | 30,0 | 14,0 | 15,5 | 22,5 | 22 | 19 | 11.10 x 1.78 |
| XSDOM NW 10 HL VA | L | PN 315 | 12 | M 16 x 1.5 | 22,5 | 12,0 | 35,0 | 16,5 | 18,0 | 25,0 | 27 | 24 | 14.00 x 1.78 |
| XSDOM NW 13 HL VA | L | PN 315 | 15 | M 18 x 1.5 | 23,5 | 12,0 | 46,0 | 21,5 | 21,5 | 28,5 | 32 | 27 | 18.77 x 1.78 |
| XSDOM NW 16 HL VA | L | PN 315 | 18 | M 22 x 1.5 | 27,5 | 12,0 | 46,5 | 21,5 | 21,0 | 28,5 | 32 | 27 | 18.77 x 1.78 |
| XSDOM NW 20 HL VA | L | PN 160 | 22 | M 26 x 1.5 | 32,5 | 16,0 | 52,0 | 24,0 | 27,5 | 35,0 | 41 | 36 | 23.81 x 2.62 |
| XSDOM NW 25 HL VA | L | PN 160 | 28 | M 33 x 2 | 39,5 | 18,0 | 64,0 | 30,5 | 32,0 | 39,5 | 50 | 46 | 29.82 x 2.62 |
| XSDOM NW 32 HL VA | L | PN 160 | 35 | M 42 x 2 | 49,5 | 20,0 | 75,0 | 35,5 | 36,0 | 46,5 | 60 | 50 | 37.77 x 2.62 |
| XSDOM NW 40 HL VA | L | PN 160 | 42 | M 48 x 2 | 55,5 | 22,0 | 88,0 | 40,5 | 40,5 | 51,5 | 70 | 60 | 41.28 x 3.53 |
| XSDOM NW 03 HS VA | S | PN 400 | 6 | M 12 x 1.5 | 17,5 | 12,0 | 30,0 | 14,0 | 16,5 | 23,5 | 22 | 19 | 11.10 x 1.78 |
| XSDOM NW 04 HS VA | S | PN 400 | 8 | M 14 x 1.5 | 18,5 | 12,0 | 30,0 | 14,0 | 16,5 | 23,5 | 22 | 19 | 11.10 x 1.78 |
| XSDOM NW 06 HS VA | S | PN 400 | 10 | M 16 x 1.5 | 22,5 | 12,0 | 35,0 | 16,5 | 18,5 | 26,0 | 27 | 24 | 14.00 x 1.78 |
| XSDOM NW 08 HS VA | S | PN 400 | 12 | M 18 x 1.5 | 23,5 | 12,0 | 35,0 | 16,5 | 18,5 | 26,0 | 27 | 27 | 18.77 x 1.78 |
| XSDOM NW 10 HS VA | S | PN 400 | 14 | M 20 x 1.5 | 25,5 | 14,0 | 46,0 | 21,5 | 22,5 | 30,5 | 30 | 27 | 18.77 x 1.78 |
| XSDOM NW 13 HS VA | S | PN 315 | 16 | M 22 x 1.5 | 27,5 | 14,0 | 46,0 | 21,5 | 22,0 | 30,5 | 30 | 27 | 18.77 x 1.78 |
| XSDOM NW 16 HS VA | S | PN 315 | 20 | M 27 x 2 | 32,5 | 16,0 | 52,0 | 24,0 | 26,5 | 37,0 | 41 | 36 | 23.81 x 2.62 |
| XSDOM NW 20 HS VA | S | PN 250 | 25 | M 33 x 2 | 39,5 | 18,0 | 64,0 | 30,5 | 31,5 | 43,5 | 50 | 46 | 29.82 x 2.62 |
| XSDOM NW 25 HS VA | S | PN 160 | 30 | M 42 x 2 | 49,5 | 20,0 | 75,0 | 35,5 | 37,0 | 50,5 | 60 | 50 | 37.77 x 2.62 |
| XSDOM NW 32 HS VA | S | PN 160 | 38 | M 48 x 2 | 55,5 | 23,0 | 87,0 | 40,5 | 41,5 | 57,5 | 70 | 60 | 41.28 x 3.53 |

PN = Nominal pressure PB = Max. operating pressure - Series: LL = Very light L = Light S = Heavy - Ø = External pipe diameter

Product versions

| | |
|----------------|----------------------------------------------------------|
| XSDOM | Banjo fitting, throttle free, angle 90°, Steel |
| SDOM VA | Banjo fitting, throttle free, angle 90°, Stainless steel |