

XWSA VA

Welded on fitting, angle 90°

HANSA FLEX

Properties

Connection 1	Welded on socket for metric pipe
Connection 2	metric cylindrical outer thread
Sealing form 2	24° inner cone
Design	Welded on fitting
Construction	Angle 90°
Standard	ISO 8434-1
Scope of supply	Socket (without union nut and cutting ring)
Material	Stainless steel

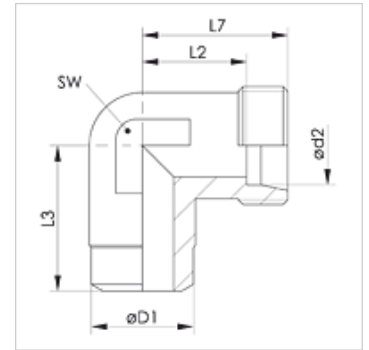

Note

Information about fitting, installation, pressure loads and permissible operating temperatures can be found in the technical information for pipe fittings.

Item

Identification	Series	Operating pressure	Ø d2 (mm)	Ø D1 (mm)	L2 (mm)	L3 (mm)	L7 (mm)	AF (mm)
XWSA NW 04 HL VA	L	PN 315	6	10	12,0	19	19	12
XWSA NW 06 HL VA	L	PN 315	8	12	14,0	23	21	12
XWSA NW 08 HL VA	L	PN 315	10	14	15,0	24	22	14
XWSA NW 10 HL VA	L	PN 315	12	16	17,0	25	24	17
XWSA NW 13 HL VA	L	PN 315	15	19	21,0	30	28	19
XWSA NW 16 HL VA	L	PN 315	18	22	23,5	33	31	24
XWSA NW 20 HL VA	L	PN 160	22	27	27,5	37	35	27
XWSA NW 25 HL VA	L	PN 160	28	32	30,5	42	38	36
XWSA NW 32 HL VA	L	PN 160	35	40	34,5	49	40	41
XWSA NW 40 HL VA	L	PN 160	42	46	40,0	57	51	50
XWSA NW 06 HS VA	S	PN 630	10	15	17,5	25	25	17
XWSA NW 08 HS VA	S	PN 630	12	17	21,5	29	29	17
XWSA NW 13 HS VA	S	PN 400	16	21	24,5	33	33	24
XWSA NW 16 HS VA	S	PN 400	20	26	26,5	37	37	27
XWSA NW 20 HS VA	S	PN 400	25	31	30,0	42	42	36
XWSA NW 25 HS VA	S	PN 400	30	36	35,5	49	49	41
XWSA NW 32 HS VA	S	PN 315	38	44	41,0	57	57	50

Series: LL = Very light L = Light S = Heavy – PN = Nominal pressure PB = Max. operating pressure – Ø = External pipe diameter

Product versions

XWSA	Welded on fitting, angle 90°, Steel
WSA VA	Welded on fitting, angle 90°, Stainless steel