

# G AOB HB

## Connectors

### Properties

<b>Connection 1</b>	BSP nut thread
<b>Sealing form 1</b>	60° outer cone with O-ring
<b>Connection 2</b>	BSP cylindrical external threads
<b>Sealing form 2</b>	60° inner cone
<b>Design</b>	Connectors
<b>Construction</b>	straight
<b>Material</b>	Steel
<b>Surface</b>	electro galvanised

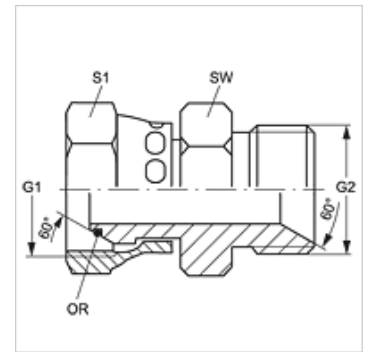

### Item

Identification	G1 + G2	AF (mm)	S1	OR
<b>G AOB 02 HB</b>	G 1/8" -28	16	14	4.5 x 1.5
<b>G AOB 04 HB</b>	G 1/4" -19	20	17	6.5 x 1.0
<b>G AOB 06 HB</b>	G 3/8" -19	24	22	8.1 x 1.6
<b>G AOB 08 HB</b>	G 1/2" -14	28	27	12.1 x 1.6
<b>G AOB 12 HB</b>	G 3/4" -14	35	32	17.1 x 1.6
<b>G AOB 16 HB</b>	G 1" -11	43	41	22.1 x 1.6
<b>G AOB 20 HB</b>	G 1.1/4" -11	52	50	29.1 x 1.6
<b>G AOB 24 HB</b>	G 1.1/2" -11	58	60	35.1 x 1.6

SW, S1, S2 = With across flats