

PHY 700 N

Swage ferrule, NY 700



Properties

| | |
|---------------------|--------------------|
| Ferrule type | Non-skive ferrule |
| Material | Steel |
| Surface | electro galvanised |

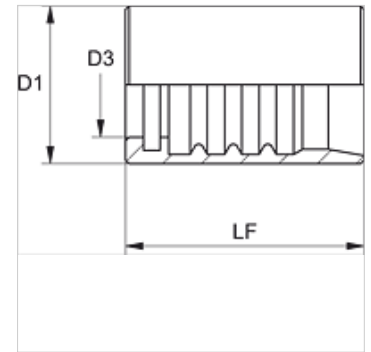

Item

| Identification | DN* | Size | Inches | D1 (mm) | D3 (mm) | LF (mm) |
|----------------|-----|------|--------|------------|------------|------------|
| PHY 704 N | 5 | 3 | 3/16" | 15,0 | 9,5 | 29,0 |
| PHY 706 N | 6 | 4 | 1/4" | 18,0 | 10,8 | 31,0 |
| PHY 708 N | 8 | 5 | 5/16" | 20,0 | 12,5 | 31,0 |
| PHY 710 N | 10 | 6 | 3/8" | 22,0 | 14,6 | 33,2 |
| PHY 713 N | 12 | 8 | 1/2" | 27,0 | 18,3 | 37,0 |

DN = Nominal diameter, nominal width

Product versions

| | |
|------------|--|
| PHY 700 VA | Swage ferrule, NY 700, Stainless steel |
|------------|--|