

# ND BD

Plug-in nipple, RGN

**HANSA FLEX**

## Properties

**Connection 1** Banjo for metric hollow screw

**Sealing form 1** Sealed by copper ring

**Connection 2 + 3** Hose connection

**Design** Double hose connection

**Short code** RGN

**Standard** DIN 7642

**Material** Steel

**Surface** electro galvanised

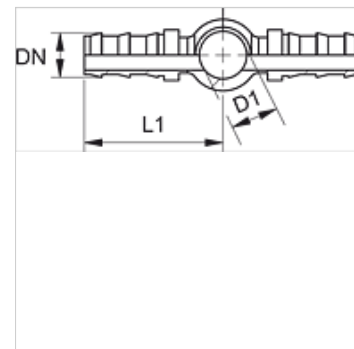

## Note

Undamaged nipples can be reused.

## Item

| Identification | DN | Size | Inches | D1<br>(mm) | for hollow screw | L1<br>(mm) |
|----------------|----|------|--------|------------|------------------|------------|
| ND 06 BD 04    | 6  | 4    | 1/4"   | 10,1       | M 10             | 42,0       |
| ND 06 BD       | 6  | 4    | 1/4"   | 12,1       | M 12             | 45,0       |
| ND 10 BD 08    | 10 | 6    | 3/8"   | 14,1       | M 14             | 49,0       |

## Accessories

ND ASR GE, RO, BL Stop ring for plug-in nipple