

SRS 1-6 IS

Hexagon socket screw, single pipe clamp

HANSA FLEX

Properties

Design	for single pipe clamps
Series	light
Standard	DIN 912 (ISO 4762)
Scope of supply	with plain washer
Material	Steel
Surface	electro galvanised

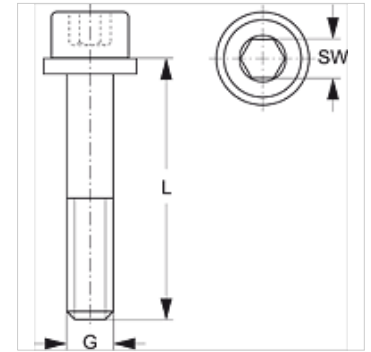

Item

Identification	Clamp size	G	L (mm)	AF (mm)
SRS IS 1	0 - 1	M 6	20	5
SRS IS 2	2	M 6	25	5
SRS IS 3	3	M 6	30	5
SRS IS 4	4	M 6	35	5
SRS IS 5	5	M 6	50	5
SRS IS 6	6	M 6	60	5

Product versions

SRS 1-6 IS V4 Hexagon socket screw, single pipe clamp, Stainless steel 1.4571

Additional element for following products

A 1-6 Configuration of group A 1-6