

WA AFL VA

Connector ... AFL, VA

Properties

Application	Connection fitting for metal hoses
Connection 1	metric nut thread
Sealing form 1	24° outer cone
Standard	matching connector adapter according to DIN 2353 / DIN EN ISO 8434-1
Short code	DKL
Construction	straight
Series	light
Material	Stainless steel

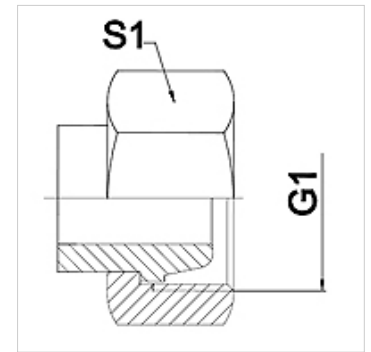

Note

Width across flats values are listed for reference purposes!

Ordering information

Other designs available on request

Item

Identification	DN	PN (bar)	G1	Series	S1 (mm)
WA 004 AFL VA	4	250	M 12 x 1.5	6 L	14,0
WA 006 AFL VA	6	250	M 14 x 1.5	8 L	17,0
WA 008 AFL VA	8	250	M 16 x 1.5	10 L	19,0
WA 010 AFL VA	10	250	M 18 x 1.5	12 L	22,0
WA 013 AFL VA	13	250	M 22 x 1.5	15 L	27,0
WA 016 AFL VA	16	160	M 26 x 1.5	18 L	32,0
WA 020 AFL VA	20	160	M 30 x 2	22 L	36,0
WA 025 AFL VA	25	100	M 36 x 2	28 L	41,0
WA 032 AFL VA	32	100	M 45 x 2	35 L	50,0
WA 040 AFL VA	40	100	M 52 x 2	42 L	60,0

Product versions

WA AFL Connector ... AFL, steel, Steel (weldable)