

HK FHP

Housing for pressure filter FHP 420 bar

HANSA FLEX

Properties

Design	without bypass valve, without clogging indicator without filter element
Operating pressure	max. 420 bar

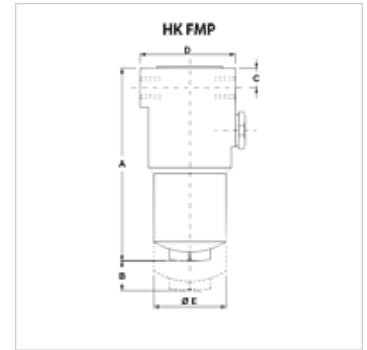

Note

Measurement "B": clearance required for changing the filter element

Description

Pressure filter for pipeline installation

Design (Qmax.) for medium ISO VG 46
at 50°C (30 mm²/s) at $\Delta p_{tot} = 1.25$ bar

Ordering information

Filter element is not included. Please order separately.

Item

Identification	Filter area (m ²)	Line connection	Q max. (L/min)	B (mm)	A (mm)	C (mm)	D (mm)	Ø E (mm)	Weight (kg)
HK FHP 065 1 SG1	386	G 1/2"	40	100	192	23	85,0	66	3,62
HK FHP 135 2 SG2	1655	G 1"	110	125	367	36	109,5	80	8,62
HK FHP 320 2 SF5	3258	1 1/4" SAE 6000 PSI/M	225	150	411	40	140,0	105	16,50

Accessories

HK VA OPT	Clogging indicator optical
HK VA EL	Clogging indicator electrical

Spare parts

HK HP H	Filter element for pressure filter FMP/FHP
---------	--