

HK FHP H

Pressure filter 420 bar complete

Properties

Design	without bypass valve, without clogging indicator A06H: with inorganic filter (6 µm), absolute filtration A10H: with inorganic filter (10 µm), absolute filtration
Operating pressure	max. 420 bar

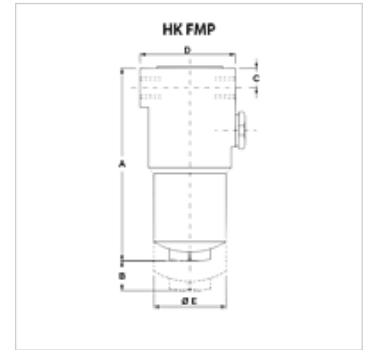

Note

Measurement "B": clearance required for changing the filter element

Description

Pressure filter for pipeline installation
 Pressure differential for filter element inorganic (A) max. 210 bar
 Design (Qmax.) for medium ISO VG 46
at 50°C (30 mm²/s) at Δptot = 1.25 bar

Ordering information

Other filter materials and filters for other types of oil, viscosities or temperatures available on request

Item

Identification	Filter area (m ²)	Line connection	Q max. (L/min)	B (mm)	A (mm)	C (mm)	D (mm)	Ø E (mm)	Weight (kg)
HK FHP 065 1 SG1 A06H	386	G 1/2"	20	100	192	23	85,0	66	3,9
HK FHP 065 1 SG1 A10H	386	G 1/2"	40	100	192	23	85,0	66	3,9
HK FHP 065 2 SG2 A10H	544	G 3/4"	45	100	221	23	85,0	66	4,2
HK FHP 065 3 SG2 A06H	1094	G 3/4"	60	100	323	23	85,0	66	5,7
HK FHP 065 3 SG2 A10H	1094	G 3/4"	70	100	323	23	85,0	66	5,7
HK FHP 135 2 SG2 A06H	1655	G 1"	110	125	367	36	109,5	80	9,4
HK FHP 135 2 SG2 A10H	1655	G 1"	110	125	367	36	109,5	80	9,4
HK FHP 320 2 SF5 A10H	3258	1 1/4" SAE 6000 PSI/M	225	150	411	40	140,0	105	16,5

A06H with inorganic filter (6 µm), absolute filtration – A10H with inorganic filter (10 µm), absolute filtration – Qmax - max intake volumetric flow

Accessories

HK VA OPT	Clogging indicator optical
HK VA EL	Clogging indicator electrical

Spare parts

HK HP H	Filter element for pressure filter FMP/FHP
HK FMP	Housing for pressure filter FMP 320 bar