

HK MPS 1

Spin-on filter type 1

Properties

Design	as return filter with bypass valve 1.75 bar, without clogging indicator A10: with inorganic filter (10 µm), absolute filtration P10: paper filter (10 µm), nominal filtration
Temp. min.	-25 °C
Temp. max.	110 °C
Material	Filter head in aluminum Gasket: NBR
Operating pressure	max. 12 bar

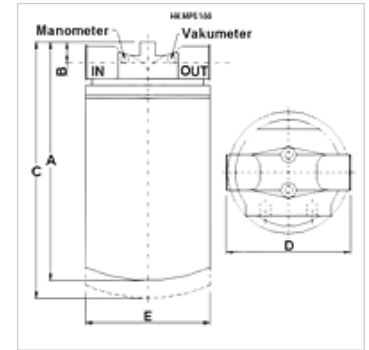

Note

For utilization as a suction filter a suction filter head FI SP S FK *** must be used.

Description

Spin-on filters for pipeline installation

Pressure differential for paper filter element (P) max. 4 bar

Pressure differential for filter inorganic element (A) max. 4 bar

Design (Qmax.) for medium ISO VG 46
at 50°C (30 mm²/s) at Δptot = 0.4 bar

Ordering information

Other filter materials and filters for other types of oil, viscosities or temperatures available on request

Item

Identification	Filter mesh size (µm)	Filter area	Line connection	Q max. (L/min)	A (mm)	B (mm)	C (mm)	D (mm)	E (mm)	Weight (kg)
HK MPS 050 RG1 A10	10,0	1900	G 3/4"	48	180	22	200	95	96	1,0
HK MPS 050 RG1 P10	10,0	2240	G 3/4"	56	180	22	200	95	96	1,0
HK MPS 070 RG1 A10	10,0	3160	G 3/4"	53	248	22	268	95	96	1,3
HK MPS 070 RG1 P10	10,0	4140	G 3/4"	65	248	22	268	95	96	1,3
HK MPS 100 RG1 A10	10,0	3950	G 1.1/4"	110	241	30	286	133	129	2,2
HK MPS 100 RG1 P10	10,0	4300	G 1.1/4"	149	241	30	286	133	129	2,2
HK MPS 150 RG1 A10	10,0	5390	G 1.1/4"	115	286	30	311	133	129	2,3
HK MPS 150 RG1 P10	10,0	5760	G 1.1/4"	156	286	30	311	133	129	2,3

A10 with inorganic filter (10 µm), absolute filtration – P10 paper filter (10 µm), nominal filtration – Qmax - max intake volumetric flow

Accessories

HK VA MAN Clogging indicator pressure gauge

Spare parts

HK MPS R/S Filter head for spin-on filter MPS