

# HK ROTEX Z

## Rotex coupling for gear pumps

### Properties

<b>Design</b>	combinable with pump mount HK HL/PL
<b>Material</b>	Steel
<b>Use</b>	For gear pumps size 2 and size 3

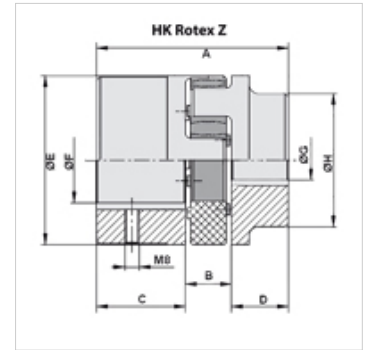

### Description

torsionally flexible, vibration damping, maintenance-free  
 Axial connection, fail-safe  
 Compact construction, low moments of inertia

### Item

Identification	A (mm)	B (mm)	C (mm)	D (mm)	Ø E (mm)	Ø F (mm)	Ø G (mm)	Ø H (mm)	Motor	Pump	Weight (kg)
HK R 28 38 N2A	79	20	35	24	65	38	17,29	35	BG132	BG2/shaft 1:8	1,18
HK R 38 42 N2A	93	24	45	24	80	42	17,29	35	BG160	BG2/shaft 1:8	1,18
HK R 28 38 N3	83	20	35	28	65	38	22,00	48	BG132	BG3/shaft 1:8	1,18
HK R 38 42 N3	97	24	45	28	80	42	22,00	48	BG160	BG3/shaft 1:8	2,06
HK R 42 48 N3	104	26	50	28	95	48	22,00	48	BG180	BG3/shaft 1:8	3,30

### Additional elements

HK MPK Selection chart for motor/pump combination for gear pumps