

Properties

| | |
|-----------------|--|
| Design | combinable with coupling HK ROTEX AF |
| Material | Aluminium |
| Use | For axial piston pump HK PVPC and vane pump HK PFE |

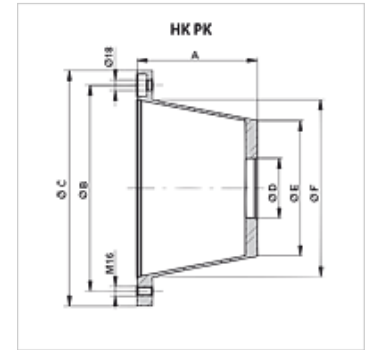

Description

Centring for motor and pump shaft

Item

| Identification | A | Ø B | Ø C | Ø D | Ø E | Ø F | Flange for pump connection | Pump | Motor | Weight |
|-------------------|--------|------|------|-------|------|------|----------------------------|--------------------|-----------|--------|
| | (mm) | (mm) | (mm) | (mm) | (mm) | (mm) | | | | (kg) |
| HK PK 350 040 400 | 188,00 | 300 | 350 | 101,6 | 225 | 260 | Two-hole flange 146 | HKPFE41 / HKPVPC30 | BG160 | 2,9 |
| HK PK 350 060 400 | 204,00 | 300 | 350 | 101,6 | 230 | 260 | Two-hole flange 146 | HKPFE41 / HKPVPC30 | BG160/180 | 3,0 |
| HK PK 350 060 500 | 204,00 | 300 | 350 | 127,0 | 230 | 260 | Two-hole flange 181 | HKPVPC50 | BG180 | 3,0 |
| HK PK 350 101 900 | 228,00 | 300 | 350 | 127,0 | 248 | 260 | Two-hole flange 181 | HKPFE52 | BG180 | 3,3 |
| HK PK 400 040 400 | 204,00 | 350 | 400 | 101,6 | 230 | 300 | Two-hole flange 146 | HKPVPC40 | BG200 | 5,3 |
| HK PK 400 040 600 | 204,00 | 350 | 400 | 127,0 | 230 | 300 | Two-hole flange 181 | HKPVPC50 | BG200 | 5,1 |
| HK PK 400 050 700 | 228,00 | 350 | 400 | 127,0 | 279 | 300 | Two-hole flange 181 | HKPFE52 | BG200 | 5,7 |
| HK PK 450 032 300 | 262,00 | 400 | 450 | 127,0 | 315 | 350 | Two-hole flange 181 | HKPVPC50 | BG225 | 6,6 |

Accessories

| | |
|--------|------------------------|
| HK DRV | Damping ring |
| HK DPT | Gasket for pump mounts |