

HK HR SUN

Hand wheel for cartridge valve SUN

HANSA FLEX

Properties

Scope of supply Handwheel and locking nut

Material Plastic / steel

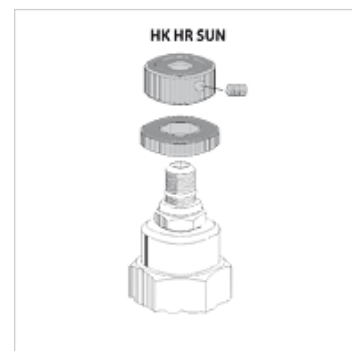

Description

For applications on SUN cartridge valves with frequent adjustments

Item

Identification	Thread	Weight (kg)
HK HR SUN	3/8" UNF IG	0,1

Accessory for following products

HK CB L	Overcentre valve CB
HK CK XCN	Non-return valve CK
HK FD	2-way directional control valve FD
HK RD	Pressure relief valve RD
HK RP	Pressure relief valve RP