

Properties

Design	Complete pistons
Operating pressure	up to 10 bar
Sliding speed max.	1,0 m/s
Temp. min.	-30 °C
Temp. max.	110 °C
Media	Mineral oils Water-air
Installation	push onto piston recess with the rubber side and affix with washer and nut.
Material	NBR 85° Shore A, with steel core
Application	Pneumatics

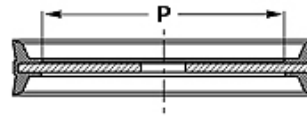

Toleranz / Tolerance		
D	d	E
H11	f8	± 0,50

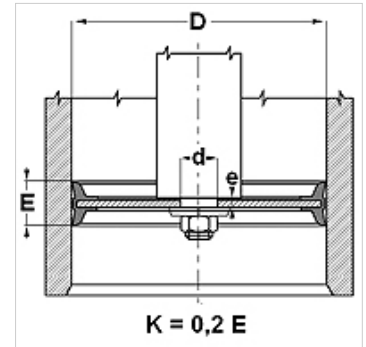

Note

Tolerance: D= H11; d= f8; E= +/-0.5

Description

Complete pistons.

Ordering information

For special operating conditions (fluid, temperature, pressure ...) please contact us.

Alternative material possible: FPM, EPDM.

Item

Identification	D (mm)	d (mm)	P (mm)	E (mm)	e (mm)
TDOP 25	25	8	15,6	12	3,8
TDOP 32	32	8	20,0	15	3,8
TDOP 40	40	10	27,0	18	4,8
TDOP 50	50	10	37,0	18	4,8
TDOP 60	60	12	43,0	22	6,0
TDOP 63	63	12	43,0	22	6,0
TDOP 063-1	63	16	43,0	22	6,0
TDOP 65	65	12	43,0	25	6,0
TDOP 70	70	12	50,0	25	6,0
TDOP 80	80	16	55,0	24	6,0
TDOP 100	100	20	75,0	26	7,0
TDOP 125	125	20	95,0	26	9,6
TDOP 160	160	27	129,0	30	10,8
TDOP 200	200	27	169,0	35	11,4