

HK FMP

Housing for pressure filter FMP 320 bar

HANSA FLEX

Properties

| | |
|--------------------|--|
| Design | without bypass valve, without clogging indicator without filter element |
| Operating pressure | max. 320 bar |

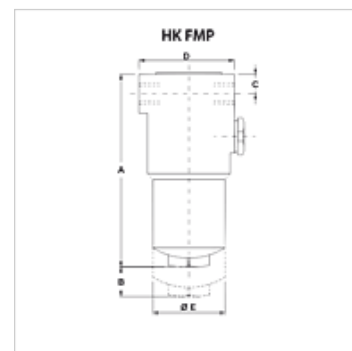

Note

Measurement "B": clearance required for changing the filter element

Description

Pressure filter for pipeline installation

Design (Qmax.) for medium ISO VG 46
at 50°C (30 mm²/s) at $\Delta p_{tot} = 1.25$ bar

Ordering information

Filter element is not included. Please order separately.

| Item | | | | | | | | |
|------------------|----------------------------------|-----------------|-----------|-----------|-----------|-----------|-------------|----------------|
| Identification | Filter area (m ²) | Line connection | B (mm) | A (mm) | C (mm) | D (mm) | Ø E (mm) | Weight (kg) |
| HK FMP 065 1 SG1 | 374 | G 1/2" | 100 | 169 | 28 | 85 | 68 | 3,9 |
| HK FMP 065 2 SG2 | 530 | G 3/4" | 100 | 200 | 28 | 85 | 68 | 4,2 |
| HK FMP 065 3 SG2 | 1064 | G 3/4" | 100 | 302 | 28 | 85 | 68 | 5,7 |
| HK FMP 135 2 SG2 | 2020 | G 1" | 125 | 333 | 38 | 104 | 77 | 9,4 |

Accessories

| | |
|-----------|-------------------------------|
| HK VA OPT | Clogging indicator optical |
| HK VA EL | Clogging indicator electrical |

Spare parts

| | |
|---------|--|
| HK HP H | Filter element for pressure filter FMP/FHP |
|---------|--|