

HK FMP H

Pressure filter 320 bar complete

Properties

Design	without bypass valve, without clogging indicator A06H: with inorganic filter (6 µm), absolute filtration A10H: with inorganic filter (10 µm), absolute filtration
Operating pressure	max. 320 bar

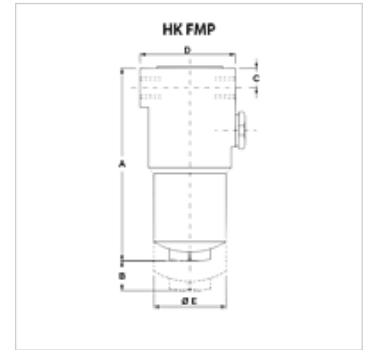

Note

Measurement "B": clearance required for changing the filter element

Description

Pressure filter for pipeline installation

Pressure differential for filter element inorganic (A) max. 210 bar

Design (Qmax.) for medium ISO VG 46
at 50°C (30 mm²/s) at Δptot = 1.25 bar

Ordering information

Other filter materials and filters for other types of oil, viscosities or temperatures available on request

Item

Identification	Filter area (m ²)	Line connection	Q max. (L/min)	B (mm)	A (mm)	C (mm)	D (mm)	Ø E (mm)	Weight (kg)
HK FMP 065 1 SG1 A06H	374	G 1/2"	20	100	169	28	85	68	3,9
HK FMP 065 1 SG1 A10H	374	G 1/2"	36	100	169	28	85	68	3,9
HK FMP 065 2 SG2 A06H	530	G 3/4"	30	100	200	28	85	68	3,9
HK FMP 065 2 SG2 A10H	530	G 3/4"	49	100	200	28	85	68	3,9
HK FMP 065 3 SG2 A06H	1064	G 3/4"	50	100	302	28	85	68	5,7
HK FMP 065 3 SG2 A10H	1064	G 3/4"	68	100	302	28	85	68	5,7
HK FMP 135 2 SG2 A06H	2020	G 1"	95	125	333	38	104	77	9,4
HK FMP 135 2 SG2 A10H	2020	G 1"	118	125	333	38	104	77	9,4
HK FMP 320 2 SF1 A06H	3645	1 1/4" SAE 6000 PSI/M	175	150	386	40	140	105	16,5
HK FMP 320 2 SF1 A10H	3645	1 1/4" SAE 6000 PSI/M	235	150	386	40	140	105	16,5

A06H with inorganic filter (6 µm), absolute filtration – A10H with inorganic filter (10 µm), absolute filtration – Qmax - max intake volumetric flow

Accessories

HK VA OPT	Clogging indicator optical
HK VA EL	Clogging indicator electrical

Spare parts

HK HP H	Filter element for pressure filter FMP/FHP
HK FMP	Housing for pressure filter FMP 320 bar