

HK X3P ABAA/ACBA

Gear pump, size 3 X3P

HANSA FLEX

Properties

Pitch circle pressure side 40/M8 up to 50.88 VFU ccm
51/M10 up to 60.81 VFU ccm

Pitch circle suction side 51/M10 up to 50.88 VFU ccm
62/M10 up to 60.81 VFU ccm

Material Housing: Aluminium
Front flange, end cover: Aluminium

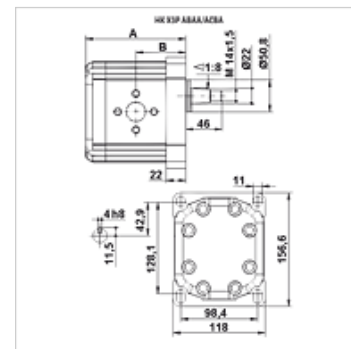

Description

European standard pump – hole pattern 128 x 98 – dia. 50.8 – taper 1:8 – flange fitting

Ordering information

Further pump versions available on request

Item

Identification	VFU (ccm) (cc)	p1 max. (bar)	p2 max. (bar)	p3 max. (bar)	A (mm)	B (mm)	Direction of rotation	Speed min. (rpm)	Speed max. (rpm)	Weight (kg)
HK X3P 70 01 ABAA	21,10	250	260	270	127	63,5	anti-clockwise rotating	700	3000	7,15
HK X3P 70 02 ABAA	21,10	250	260	270	127	63,5	clockwise rotating	700	3000	7,15
HK X3P 72 01 ABAA	26,06	250	260	270	131	65,5	anti-clockwise rotating	700	3000	7,25
HK X3P 72 02 ABAA	26,06	250	260	270	131	65,5	clockwise rotating	700	3000	7,25
HK X3P 74 01 ABAA	32,27	250	260	270	136	68,0	anti-clockwise rotating	700	3000	7,39
HK X3P 74 02 ABAA	32,27	250	260	270	136	68,0	clockwise rotating	700	3000	7,39
HK X3P 78 01 ABAA	38,47	250	260	270	141	70,5	anti-clockwise rotating	700	2800	7,52
HK X3P 78 02 ABAA	38,47	250	260	270	141	70,5	clockwise rotating	700	2800	7,52
HK X3P 79 01 ABAA	43,44	250	260	270	145	72,5	anti-clockwise rotating	700	2800	7,63
HK X3P 79 02 ABAA	43,44	250	260	270	145	72,5	clockwise rotating	700	2800	7,63
HK X3P 81 01 ABAA	50,88	230	240	250	151	75,5	anti-clockwise rotating	700	2800	7,79
HK X3P 81 02 ABAA	50,88	230	240	250	151	75,5	clockwise rotating	700	2800	7,79
HK X3P 83 01 ACBA	60,81	230	240	250	159	79,5	anti-clockwise rotating	700	2300	8,01
HK X3P 83 02 ACBA	60,81	230	240	250	159	79,5	clockwise rotating	700	2300	8,01
HK X3P 87 01 ACBA	74,46	180	190	200	170	85,0	anti-clockwise rotating	700	2300	8,30
HK X3P 87 02 ACBA	74,46	180	190	200	170	85,0	clockwise rotating	700	2300	8,30

VFU = conveying volume per revolution – p1 = continuous pressure – p2 = working pressure – p3 = maximum pressure

Accessories

WDA Pump connection (3 hole), angle 90°

WDS Pump connection (3 hole), angle 90°

F Pump connection (4 hole)

FE Pump connection (4 hole)

Additional elements

HK MPK Selection chart for motor/pump combination for gear pumps