

# TW-TG MG

Tanker fitting, brass

**HANSA FLEX**

## Properties

<b>Application</b>	Tankers
<b>Connection 1</b>	Hose connection
<b>Connection 2</b>	BSP cylindrical external threads
<b>Design</b>	with safety collar
<b>Standard</b>	DIN EN 14 420-5
<b>Material</b>	Brass

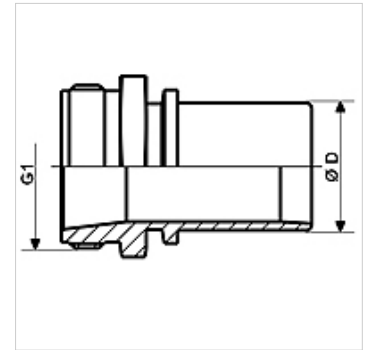

## Item

Identification	DN*	Ø D (mm)	G1	Max. working pressure (bar)
TW-TG 12 13 MG	13	13,4	G 1/2" -14	16
TW-TG 34 19 MG	19	19,4	G 3/4" -14	16
TW-TG 10 19 MG	19	19,4	G 1" -11	16
TW-TG 10 25 MG	25	25,4	G 1" -11	16
TW-TG 114 32 MG	31	32,4	G 1.1/4" -11	16
TW-TG 112 35 MG	35	35,0	G 1.1/2" -11	16
TW-TG 112 38 MG	38	38,4	G 1.1/2" -11	16
TW-TG 20 38 MG	38	38,4	G 2" -11	16
TW-TG 20 50 MG	50	50,4	G 2" -11	16
TW-TG 212 63 MG	63	63,4	G 2.1/2" -11	16
TW-TG 30 75 MG	75	75,4	G 3" -11	16
TW-TG 30 80 MG	80	80,4	G 3" -11	16
TW-TG 40 100 MG	100	100,4	G 4" -11	16

DN = Nominal diameter, nominal width

## Product versions

TW-TG VA Tank truck fitting, stainless steel, Stainless steel

## Accessories

KS AL	Clamp ring fitting, aluminium
KS FIX AL	Clamping shell for pinning, aluminium

## Accessory for following products

TW	Tank truck hose
TW OW	Tank truck hose without helix