

WFG (6000 PSI)

SAE flange adapter, forged

Properties

Pressure series	6000 psi
Standard	DIN 3901/3902
Construction type	forged
Construction	Angle 90°
Design	SAE flange adapter
Scope of supply	flange only
Material	S355J2G3 (ST52.3)
Surface	electro galvanised

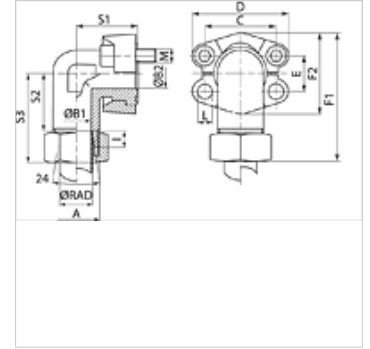

Note

The stated maximum working pressure relates to the flange. The actual working pressure is determined by the pipe (wall thickness) and the quality of the pipe.

Recommended screws are listed in the columns M (metr) and M (unc).

Item

Identification	Series	Ø RAD (mm)	PB 10.9 (bar)	Size	A	B1 (mm)	B2 (mm)	F1 (mm)	I (mm)	S1 (mm)	S2 (mm)	S3 (mm)	L (mm)	M metr.
WFG 6001/S 16	S	16	400	1/2"	M24x1,5	12	12	71,6	8,5	39	29,4	48	8,7	M 8 x 30
WFG 6002/S 16	S	16	400	3/4"	M24x1,5	12	17	85,0	8,5	48	36,5	55	10,7	M 10 x 35
WFG 6002/S 20	S	20	400	3/4"	M30x2	16	17	87,0	10,5	48	35,5	57	10,7	M 10 x 35
WFG 6002/S 25	S	25	400	3/4"	M36x2	17	17	90,0	12,0	48	36,0	60	10,7	M 10 x 35
WFG 6003/S 25	S	25	400	1"	M36x2	20	24	99,8	12,0	60	41,0	65	13,0	M 12 x 45
WFG 6003/S 30	S	30	400	1"	M42x2	24	24	102,9	13,5	60	41,5	68	13,0	M 12 x 45
WFG 6004/S 30	S	30	400	1.1/4"	M42x2	25	31	109,6	13,5	68	44,5	71	14,7	M 14 x 50
WFG 6004/S 38	S	38	350	1.1/4"	M52x2	28	31	114,6	16,0	68	45,0	76	14,7	M 14 x 50
WFG 6005/S 38	S	38	350	1.1/2"	M52x2	30	36	134,5	16,0	76	56,0	87	17,0	M 16 x 55

Series: LL = Very light L = Light S = Heavy - PN = Nominal pressure PB = Max. operating pressure - Ø RAD = External pipe diameter

Product versions

WFG M (3000 / 6000 PSI) SAE flange adapter, forged, with 2 flange halves, screw set and O-ring