

# K-DRUCKSCHALTER VAKUUM

Combined vacuum/pressure switch

**HANSA FLEX**

## Properties

<b>Design</b>	PNP
<b>Measured medium</b>	G 1/8 male and M 5 female
<b>Hysteresis</b>	Adjustable: 3 to 25% of set value
<b>Temp. range</b>	0 - 50 °C
<b>Media</b>	Non-aggressive gases. dry, oil-free air
<b>Housing</b>	Polycarbonate
<b>Output signal</b>	Analogue: 1 to 5 V
<b>Electrical connection</b>	Male connector M8, four pin
<b>Switching capacity</b>	125 mA
<b>Current consumption</b>	30 mA
<b>status indicator</b>	LED

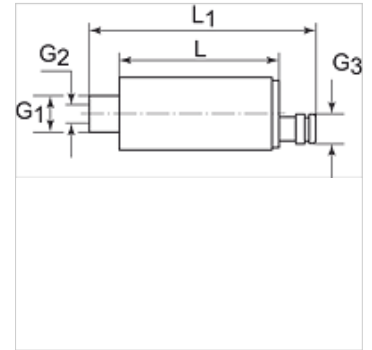
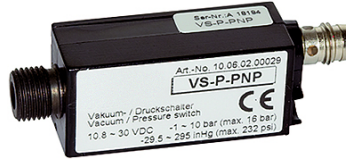

## Note

Further information on request

## Description

Universal electronic vacuum and pressure switch for safety monitoring, optimisation of cycle times and regulation circuits. Its small size and low weight permit installation directly at the point of use. Suitable for all special applications in the vacuum and compressed air sectors. Adjustable vacuum limit value and continuous vacuum monitoring.

## Item

Identification	G1 Malethread	G2 Femalethread	G3 Malethread	L (mm)	L1 (mm)	Measuring range	Voltage
K- 07 45 01 31	G 1/8	M 5	M 8 x 1	44,0	62,0	-1 bis +10 bar	10.8 - 30 V DC