

# K-VAKUUMSCHALTER

Vacuum switch

**HANSA FLEX**

## Properties

<b>Measured medium</b>	G 1/8 male and M 5 female
<b>Output signal</b>	Analogue: 1 to 5 V
<b>Electrical connection</b>	Male connector M8, four pin
<b>Hysteresis</b>	Adjustable: 3 to 25% of set value
<b>Media</b>	Non-aggressive gases. dry, oil-free air
<b>Switching function</b>	PNP
<b>Switching capacity</b>	125 mA
<b>Current consumption</b>	30 mA
<b>Temp. range</b>	0 - 50 °C
<b>Housing</b>	Polycarbonate

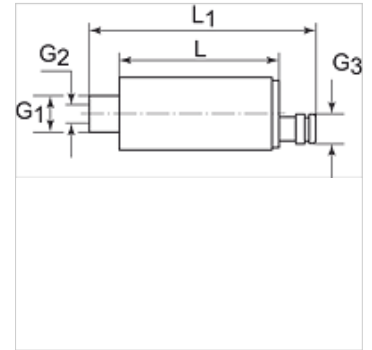
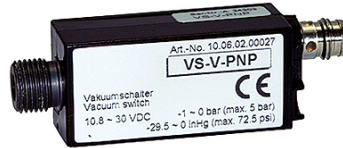

## Note

Further information on request

## Description

Universal electronic vacuum switch for safety monitoring, optimisation of cycle times and regulation circuits. Its small size and low weight permit installation directly on the suction pad. <br>Switching point and hysteresis adjustable with a screw. Integrated LED for indication of the switching state.

Item							
Identification	G1 Malethread	G2 Femalethread	G3 Malethread	L (mm)	L1 (mm)	Measuring range	Voltage
K- 07 45 01 58	G 1/8	M 5	M 8 x 1	44,0	62,0	-1 bis 0 bar	10.8 - 30 V DC