

# K-DRS ELK GERAETESTECKER

Pressure switches, connection with plug connector, type A acc. to DIN 43650

**HANSA FLEX**

## Properties

Application	Pneumatic applications
Switching frequency	200/min.
Switching voltage	max. 250 V AC / 28 V DC
Protection IP	IP 65 (DIN 43650), IP 67 (M 12 x 1)
Temp. range	-10 °C to +80 °C
Setting cap	Aluminium, powder-coated
Housing	Special die-cast material
Diaphragm, seal	NBR

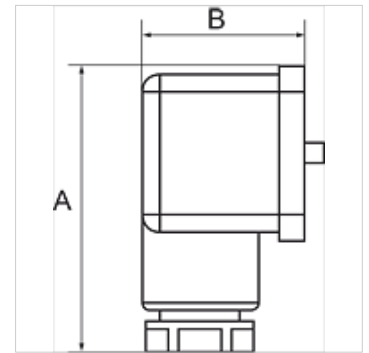

## Note

Further information on request

## Description

For converting pneumatic to electrical signals. Designed for use in rough vacuum applications (technical vacuum). Universal switch type, suitable as NC, NO or changeover contact. These devices are free from paint-wetting impairment substances (PWIS).

Item				
Identification	Connection	Adjustment range	A (mm)	B (mm)
K- 07 30 28 45	G 1/4	0,2 - 2,0 bar	48,0	28,0
K- 07 30 28 46	G 1/4	0,5 - 8,0 bar	48,0	28,0
K- 07 30 28 47	G 1/4	1,0 - 16,0 bar	48,0	28,0