

K-W90 STUECK AG AG 2 2

Elbows, male-male

HANSA FLEX

Properties

Operating pressure 60 bar

Operating temperature Max. 150 °C

Material Brass with a bare metal surface

Male thread conical acc. DIN 2999

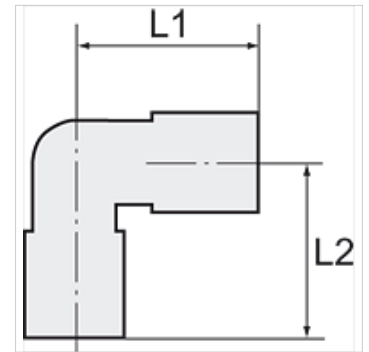

Note

Further information on request

Item

Identification	Thread	L1 (mm)	L2 (mm)	AF
K- 07 40 11 22	R 1/8	18,5	18,5	10 mm
K- 07 40 11 23	R 1/4	23,5	23,5	13 mm
K- 07 40 11 24	R 3/8	26,0	26,0	17 mm
K- 07 40 11 25	R 1/2	31,0	31,0	21 mm
K- 07 40 11 26	R 3/4	33,0	33,0	25 mm
K- 07 40 11 27	R 1	39,0	39,0	30 mm