

# K-W90 SCHLAUCH VB

Elbow hose connectors

**HANSA FLEX**

## Properties

<b>Operating pressure</b>	Dependent on operating temperature; Max. 10 bar (at 20 °C); Max. 1 bar (at 60 °C)
<b>Threaded connection body</b>	Polyamide (PA)
<b>Clamp ring</b>	Polypropylene (PP)
<b>Nut</b>	Polypropylene (PP)

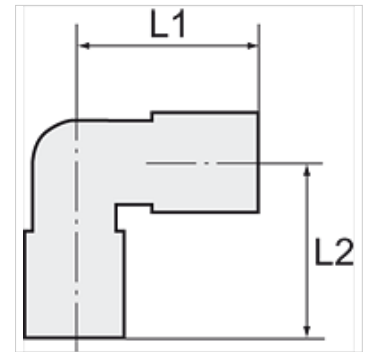

## Note

Further information on request

## Description

Manufactured from high impact-resistant, UV-stabilised engineering plastic, extremely resistant to weathering. Good chemical resistance to benzene, diesel oil, fuel oil and alkalis. <br>Not suitable for use with acids.

## Item

Identification	for hose	L1 (mm)	L2 (mm)
K- 07 40 32 66	4 mm / 6 mm	25,0	25,0
K- 07 40 32 67	6 mm / 8 mm	30,0	30,0
K- 07 40 32 68	8 mm / 10 mm	36,0	36,0
K- 07 40 32 69	9 mm / 12 mm	43,0	43,0