

# K-W90 AG

Male elbows with male G thread

**HANSA FLEX**

## Properties

Operating pressure	Dependent on operating temperature; Max. 10 bar (at 20 °C); Max. 1 bar (at 60 °C)
Threaded connection body	Polyamide (PA)
Clamp ring	Polypropylene (PP)
Nut	Polypropylene (PP)

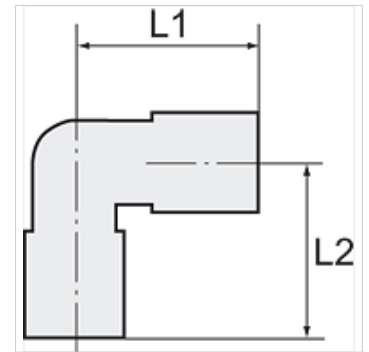

## Note

Further information on request

## Description

Manufactured from high impact-resistant, UV-stabilised engineering plastic, extremely resistant to weathering. Good chemical resistance to benzene, diesel oil, fuel oil and alkalis. <br>Not suitable for use with acids.

## Item

Identification	Thread	for hose	L1 (mm)	L2 (mm)
K- 07 40 32 82	G 1/8	4 mm / 6 mm	25,0	20,0
K- 07 40 32 83	G 1/8	6 mm / 8 mm	30,0	23,0
K- 07 40 32 84	G 1/8	8 mm / 10 mm	36,0	25,0
K- 07 40 32 85	G 1/8	9 mm / 12 mm	40,0	27,0
K- 07 40 32 86	G 1/4	4 mm / 6 mm	26,0	25,0
K- 07 40 32 87	G 1/4	6 mm / 8 mm	30,0	27,0
K- 07 40 32 88	G 1/4	8 mm / 10 mm	36,0	32,0
K- 07 40 32 89	G 1/4	9 mm / 12 mm	40,0	31,0
K- 07 40 32 90	G 3/8	4 mm / 6 mm	29,0	30,0
K- 07 40 32 91	G 3/8	6 mm / 8 mm	33,0	27,0
K- 07 40 32 92	G 3/8	8 mm / 10 mm	36,0	29,0
K- 07 40 32 93	G 3/8	9 mm / 12 mm	40,0	31,0
K- 07 40 32 94	G 1/2	4 mm / 6 mm	32,0	29,0
K- 07 40 32 95	G 1/2	6 mm / 8 mm	36,0	29,0
K- 07 40 32 96	G 1/2	8 mm / 10 mm	39,0	31,0
K- 07 40 32 97	G 1/2	9 mm / 12 mm	43,0	33,0