

# K-DRGREDV

## Pressure reducing valves

### Properties

<b>Input pressure</b>	Max. 15 bar
<b>Connection</b>	G 1/4 internal / external
<b>Material</b>	Brass

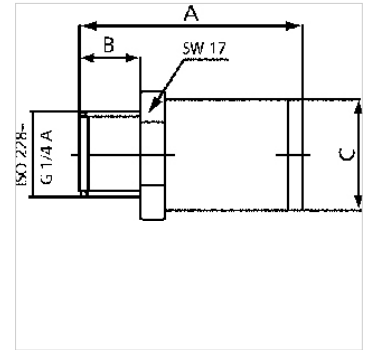
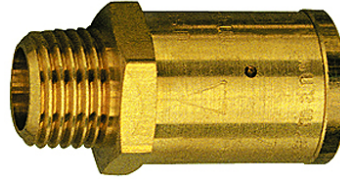

### Note

Dependent on the input pressure P1, the initial pressure P2 can vary between -20% to +20%  
Further information on request

### Description

Industry, trade and repair shops often require working pressures of 15 bar or less. These pressure reducing valves, which are screwed directly onto the tool, enable the actually necessary working pressure to be set. <br>Benefits: Significantly reduced risk of accidents, Longer tool life with fewer malfunctions, Lower noise levels at the workplace.

### Item

Identification	Set pressure	max. flow rate (L/min)	A (mm)	B	Ø C (mm)	AF (mm)
K- 07 25 19 31	2,0	300	34,0	9.0 mm	17,0	17
K- 07 25 02 00	3,0	360	34,0	9.0 mm	17,0	17
K- 07 25 02 01	4,0	380	34,0	9.0 mm	17,0	17
K- 07 25 02 02	5,0	390	34,0	9.0 mm	17,0	17
K- 07 25 02 03	6,0	405	34,0	9.0 mm	17,0	17
K- 07 25 19 32	7,0	415	34,0	9.0 mm	17,0	17
K- 07 25 19 33	8,0	420	34,0	9.0 mm	17,0	17