

# K-BEFUELLEINHEIT 24VDC HANSA

Filling units, electrically operated, with 24 VDC / 2.5 W solenoid, adjustable filling time

**HANSA FLEX**

## Properties

|  |   |
|--|---|
| Input pressure                         | 2 - 10 bar                                      |
| Temp. range                            | -10 °C to +50 °C                                |
| Media                                  | Compressed air                                  |
| rush-in power alternating current 50Hz | 2,2 VA  |
| Duty cycle                             | ED 100 %  |
| Electrical connection                  | Connector type C, ISO 15217, 2 poles + PE       |
| holding power alternating current 50Hz | 1,6 VA  |
| Power consumption DC                   | 2,5 W   |
| Protection IP                          | IP 65   |
| Connection thread                      | Material: Die-cast zinc                         |
| Housing                                | Material: Grivory® (PA 66)                      |
| Flow rate measurement                  | At P2 = 6 bar, pressure drop $\Delta p$ = 1 bar |

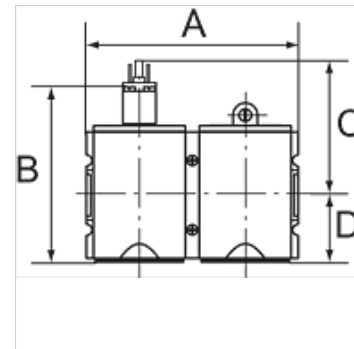

## Note

Further information on request

## Description

The filling unit protects devices connected downstream by ensuring a gradual build-up of pressure. The unit consists of a 3/2-way valve and a filling valve (start-up valve). It is connected and disconnected by means of the 3/2-way valve. The filling time can be altered by turning the adjusting screw.

## Ordering information

Filling units are also available with coil 110 V AC, 50 Hz and in a pneumatically operated version. Please ask for more information.

## Item

| Identification | Thread | Outlet | Flow rate (L/min) | A (mm) | B        | C (mm) | D (mm) |
|----------------|--------|--------|-------------------|--------|----------|--------|--------|
| K- 07 25 10 99 | G 1/4  | 1/4    | 1300              | 104,0  | 117.8 mm | 84,8   | 33,0   |
| K- 07 25 11 00 | G 3/8  | 1/4    | 1300              | 104,0  | 117.8 mm | 84,8   | 33,0   |
| K- 07 25 11 25 | G 3/8  | 1/2    | 3400              | 126,0  | 150.3 mm | 93,8   | 56,5   |
| K- 07 25 11 26 | G 1/2  | 1/2    | 3400              | 126,0  | 150.3 mm | 93,8   | 56,5   |
| K- 07 25 11 47 | G 3/4  | 1/2    | 8750              | 170,0  | 177.7 mm | 110,7  | 67,0   |
| K- 07 25 11 48 | G 1    | 1/2    | 8750              | 170,0  | 177.7 mm | 110,7  | 67,0   |

## Accessories

|                             |   |
|-----------------------------|---|
| K-SCHALLDAE SINTERBR S      | Silencers, sintered bronze, slotted                                 |
| K-SCHALLDAE SINTERBR GE MS1 | Silencers, sintered bronze, with brass hexagon nut and brass thread |

## Spare parts

|                         |                            |
|-------------------------|----------------------------|
| K-HALTERBAUSATZ HANSA   | Holder HANSA               |
| K-VORSTEUERVENTIL HANSA | Replacement solenoid HANSA |
| K-GERAETESTECKER FORM C | Connector                  |