

# K-FI PC-BEHAEL H ABLV MULTIFX MINI

Filters with polycarbonate bowl and semi-automatic drain valve

**HANSA FLEX**

## Properties

<b>Input pressure</b>	Max. 16 bar (polycarbonate bowl), Max. 20 bar (metal bowl)
<b>Media temperature</b>	max. 60 °C
<b>Ambient temperature</b>	Max. 60 °C
<b>Flow rate</b>	1000 l/min
<b>Pore size in filter element</b>	5 µm
<b>Housing</b>	Die-cast zinc
<b>Drain valve</b>	Semi-automatic
<b>Flow rate measurement</b>	At P2 = 6 bar and pressure drop $\Delta p = 1$ bar

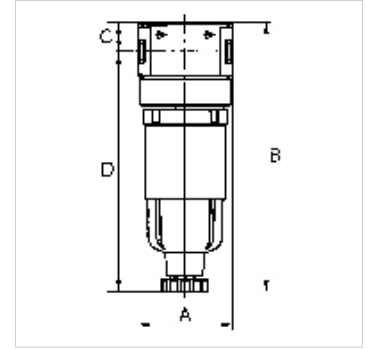

## Note

If several devices in the »multifix-mini« Series are assembled together, the maximum working pressure is 12 bar.  
Further information on request

## Description

Centrifugal separators with a sintered filter element.

## Item

Identification	Thread	A (mm)	B	C (mm)	D (mm)	DN	Size
K- 07 25 00 42	G 1/8	40,0	114.8 mm	12,3	102,5	5	0
K- 07 25 00 44	G 1/4	40,0	114.8 mm	12,3	102,5	5	0

## Spare parts

K-AUTOMAT ABLASSVENTIL	Automatic drain valve
K-KOPPELPAKET MEHR	Coupling packet
K-ERSATZBEHAELTER MULTI MINI	Spare tank »multifix-mini« & »standard-mini«
K-PC-BEHAELTER FILTER MULTIFIX	Polycarbonate tank filter
K-FILTERELEMENT	Filter element