

# K-VORFI METALLBEHAEL MULTIFIX MINI

Pre-filters with metal bowl

**HANSA FLEX**

## Properties

Input pressure	Max. 16 bar
Media temperature	max. 60 °C
Ambient temperature	Max. 60 °C
Filter rating	0,30 µm
Efficiency	99.999 %
Sealant	NBR
Filter insert	Paper-POM
Housing	Die-cast zinc
Drain valve	Semi-automatic
Flow rate measurement	FV at P1 = 6 bar and pressure drop $\Delta p = 0.02$ bar

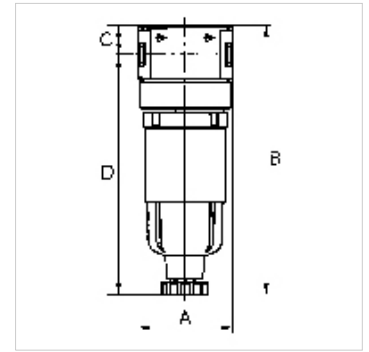

## Note

If several devices in the »multifix-mini« Series are assembled together, the maximum working pressure is 12 bar.  
Further information on request

## Description

Micro-filters for compliance with strict compressed air purity requirements. Suitable for all applications where standard filters do not afford the desired efficiency.

Item							
Identification	Thread	Flow rate (L/min)	A (mm)	B	C (mm)	D (mm)	DN
K- 07 25 10 65	G 1/8	130	40,0	111.6 mm	12,3	102,5	5
K- 07 25 10 67	G 1/4	160	40,0	138.1 mm	12,3	125,8	5

## Spare parts

K-AUTOMAT ABLASSVENTIL	Automatic drain valve
K-KOPPELPAKET MEHR	Coupling packet