

# K-FI AK KOH METALLBEHAE MULTIFIX MI

Activated carbon filters with metal bowl

**HANSA FLEX**

## Properties

Input pressure	Max. 16 bar
Media temperature	max. 60 °C
Ambient temperature	Max. 60 °C
Sealant	NBR
Filter insert	Activated carbon-POM
Housing	Die-cast zinc
Drain valve	Semi-automatic
Residual oil content	0.005 mg/m3
Flow rate measurement	FA at P1 = 6 bar and pressure drop $\Delta p = 0.2$ bar

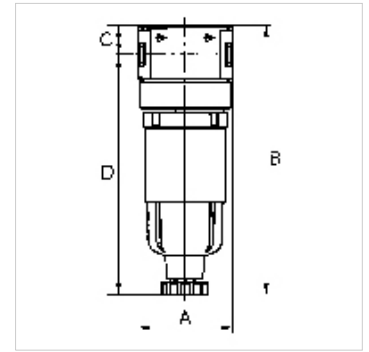

## Note

If several devices in the »multifix-mini« Series are assembled together, the maximum working pressure is 12 bar.  
Further information on request

## Description

Micro-filters for compliance with strict compressed air purity requirements. Suitable for all applications where standard filters do not afford the desired efficiency.

Item								
Identification	Thread	Flow rate (L/min)	A (mm)	B	C (mm)	D (mm)	DN	Size
K- 07 25 10 46	G 1/8	310	40,0	97.3 mm	12,3	85,0	5	0

## Spare parts

K-AUTOMAT ABLASSVENTIL	Automatic drain valve
K-KOPPELPAKET MEHR	Coupling packet
K-ERSATZBEHAELTER MULTI MINI	Spare tank »multifix-mini« & »standard-mini«