

K-RD DURCHGANGSFORM LEI VA

Check valve - straight-way type, lightweight series, stainless steel

HANSA FLEX

Properties

Operating pressure	2 - 16 bar
Operating temperature	-20 °C to +150 °C
Opening pressure	min. 0.03 bar
Sealant	FKM
Spring	Stainless steel 1.4301
Housing	Stainless steel 1.4301

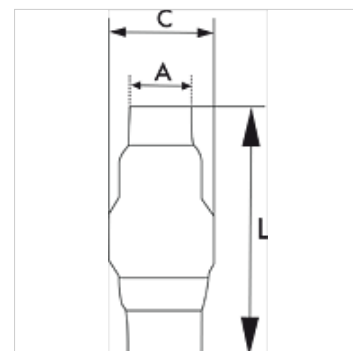

Note

Further information on request

Description

Stainless steel check valve with full bore and very low opening pressure, no maintenance required. Applications: Compressed air, water, neutral gases, gaseous and liquid non-corrosive media, oils.

Item

Identification	Thread	A (mm)	C (mm)	L (mm)
K- 07 30 29 23	G 1/4	20,0	32,0	55,9
K- 07 30 29 28	G 3/8	20,0	32,0	56,0
K- 07 30 29 22	G 1/2	25,0	32,0	55,6
K- 07 30 29 27	G 3/4	29,0	44,0	66,7
K- 07 30 29 19	G 1	36,0	53,0	83,6
K- 07 30 29 21	G 1 1/4	45,0	62,0	96,0
K- 07 30 29 20	G 1 1/2	51,0	78,0	114,0
K- 07 30 29 24	G 2	64,0	89,0	120,5
K- 07 30 29 25	G 2 1/2	80,0	113,0	141,5
K- 07 30 29 26	G 3	94,0	132,0	160,0